

TCEQ Interoffice Memorandum

To: Office of the Chief Clerk
Texas Commission on Environmental Quality

Thru: Chris Kozlowski, Team Leader
Water Rights Permitting Team

From: Lillian E. Beerman, Ph.D., Project Manager
Water Rights Permitting Team

Date: July 18, 2022

Subject: City of Bryan
ADJ 5309
CN600373310, RN108452137
Application No. 12-5309A to amend Certificate of Adjudication
No. 12-5309
Texas Water Code §§ 11.122, 11.042, Requiring Published and
Mailed Notice
Unnamed tributary of Burton Creek, Brazos River Basin
Brazos County

The application and partial fees were received on April 19, 2022. Additional information and fees were received on June 14 and 21, 2022. The application was declared administratively complete and filed with the Office of the Chief Clerk on July 18, 2022. Published and mailed notice to water right holders of record in the Brazos River Basin is required pursuant to Title 30 Texas Administrative Code (TAC) §§ 295.158(b)(4) and (b)(7); notice to the Texas Parks and Wildlife Department and the Public Interest Council is required pursuant to Title 30 TAC § 295.161(c); and mailed notice to the Brazos Valley Groundwater Conservation District is required pursuant to Title 30 TAC § 295.153(b)(3).

All fees have been paid and the application is sufficient for filing.

Lillian E. Beerman, Ph.D.

Lillian E. Beerman, Ph.D., Project Manager
Water Rights Permitting Team
Water Rights Permitting and Availability Section

OCC Mailed Notice Required

YES

NO

Jon Niermann, *Chairman*
Emily Lindley, *Commissioner*
Bobby Janecka, *Commissioner*
Toby Baker, *Executive Director*



TEXAS COMMISSION ON ENVIRONMENTAL QUALITY

Protecting Texas by Reducing and Preventing Pollution

July 18, 2022

Mr. Paul Kaspar, PE, City Engineer
City of Bryan
300 S. Texas Ave.
Bryan, TX 77803

VIA E-MAIL

RE: City of Bryan
ADJ 5309
CN600373310, RN108452137
Application No. 12-5309A to amend Certificate of Adjudication No. 12-5309
Texas Water Code §§ 11.122, 11.042, Requiring Published and Mailed Notice
Unnamed tributary of Burton Creek, Brazos River Basin
Brazos County

Dear Mr. Kaspar:

This acknowledges receipt of additional information and fees, in the amount of \$47.00, on June 14 and 21, 2022 (Receipt No. M218465, copy attached).

The application was declared administratively complete and filed with the Office of the Chief Clerk on July 18, 2022. Staff will continue processing the application for consideration by the Executive Director.

Please be advised that additional information may be requested during the technical review phase of the application process.

If you have any questions concerning the application, please contact me at lillian.beerman@tceq.texas.gov or by phone at (512) 239-4019.

Sincerely,

Lillian E. Beerman, Ph.D.

Lillian E. Beerman, Ph.D., Project Manager
Water Rights Permitting Team
Water Rights Permitting and Availability Section

Attachment



Basis2 Receipt Report by Endorsement Number

JUN-23-22 10:47 AM

Acct. #: WUP

Account Name: WATER USE PERMITS

<u>Paid For</u>	<u>Endors. #</u>	<u>Ref #2</u>	<u>Paid In By</u>	<u>PayTyp</u>	<u>Chk #</u>	<u>Card#</u>	<u>Bank Slip</u>	<u>Tran.Date</u>	<u>Receipt Amnt.</u>
AMENDMENT	M218465	ADJ80J5309	BRYAN, CITY OF	CK	480512		BS00095610	21-JUN-22	\$47.00

Application No. 12 5309A Administrative Review Response Letter

Tristen Fisher [REDACTED]

Tue 6/14/2022 2:12 PM

To: Lillian Beerman Lillian.Beerman@Tceq.Texas.Gov

Cc: Kaspar, W. Paul [REDACTED]; Veronica Morgan [REDACTED]

Lillian,

As per our conversation, I have addressed all of your comments in the attached document. Please let me know if you have any questions and if there is anything else you need from us at this time to proceed with the technical review.

Tristen Fisher
Graduate Engineer

[Mitchell and Morgan, LLP](#)

3204 Earl Rudder Fwy. S.

College Station, Texas 77845-6457

T [979 260 6963](tel:9792606963)

Providing Solutions for a Better Tomorrow...

CONFIDENTIALITY NOTE

This email and any files transmitted with it contain privileged and confidential information and are intended solely for the use of the individual or entity to which they are addressed. If you are not the intended recipient or the person responsible for delivering the email to the intended recipient, you are hereby notified that any dissemination or copying of this email or any of its attachment(s) is strictly prohibited. If you have received this email in error, please immediately notify the sending individual or entity by email and permanently delete the original email and attachment(s) from your computer system



Lillian E. Beerman, Ph.D.
Project Manager
TCEQ Water Rights Permitting Team
12100 Park 35 Circle,
Austin, Texas 78753

June 14, 2022

RE: Application No. 12-5309A Administrative Review Comments

Dear Lillian,

Please see the responses to your comments below.

Water Rights Permitting (Lillian E. Beerman)

1. Confirm the coordinates for the diversion point. Staff has calculated the following coordinates on the perimeter of the reservoir to be Latitude 30.641445° N and Longitude 96.363228° W as described in the certificate.

Response: Applicant intends to divert water anywhere along the perimeter of the reservoir with the center of the located at Latitude 30.640103° N and Longitude 96.359022° W.

2. Confirm the coordinates for the discharge point of well #1. Staff has calculated the following coordinates on the watercourse to be Latitude 30.640942° N and Longitude 96.364730° W.

Response: Applicant confirms these coordinates as the discharge point of well #1.

3. Before the application can be declared administratively complete, remit fees in the amount of \$47.00, as described below. Please make the check payable to the TCEQ or Texas Commission on Environmental Quality.

Response: The City of Bryan has mailed a check in the amount of \$47.00 made payable to TCEQ.

If you have any questions or comments, please feel free to call our office at 979-260-6963.

Sincerely,

Veronica JB Morgan, PE, CFM
Managing Partner

cc: File

PHONE MEMO

From: Lillian Beerman	TO: Tristin Fisher
Phone: 979-260-6963	Document: City of Bryan COA No. 12-5309A
Date: June 10, 2022	RE: Request for Information

Response to Mr. Fisher's question of 6/9/22 after speaking with Hydrologist.

If the applicant is still in the design phase of a project, they will often use as their coordinate the following phrase: "anywhere along the perimeter of the reservoir, with the center point of the dam located at *Lat/Long*."

Mr. Fisher said that would work.

Lillian E. Beerman, Ph.D. June 10, 2022

PHONE MEMO

From: Lillian Beerman	TO: Tristin Fisher
Phone: 979-260-6963	Document: City of Bryan COA 12-5309A
Date: June 9, 2022	RE: Request for Information

Tristin's questions regarding the RFI:

Wants to know about confirming coordinates:

1. The diversion point location they chose was arbitrary. The construction on the project has not yet begun. They can confirm the points, but what if the project changes during construction?
2. The discharge point location is the well. It is the same point as the location in the permit with the groundwater conservation district. However, that point is for the well not the discharge location. They can confirm if this poses no problem.

Lillian E. Beerman, Ph.D. June 9, 2022

City_of_Bryan_12-5309A_Request for Information

Lillian Beerman <Lillian.Beerman@Tceq.Texas.Gov>

Thu 6/2/2022 12:32 PM

To:



Cc: Lillian Beerman <Lillian.Beerman@Tceq.Texas.Gov>

 1 attachments (129 KB)

City_of_Bryan_12-5309A_RFI_Sent_06.02.2022.pdf;

Mr. Paul Kaspar,

A Request for Information has been sent regarding the City of Bryan's Application No. 12-5309A to amend COA No. 12-5309. See Attached.

Please respond by COB Tuesday, July 5, 2022.

If you have any questions or concerns, do not hesitate to contact me.

Thank you,

Lillian E. Beerman, Ph.D.
Water Rights Permitting Team
Water Availability Division
512-239-4019
lillian.beerman@tceq.texas.gov

Jon Niermann, *Chairman*
Emily Lindley, *Commissioner*
Bobby Janecka, *Commissioner*
Toby Baker, *Executive Director*



TEXAS COMMISSION ON ENVIRONMENTAL QUALITY

Protecting Texas by Reducing and Preventing Pollution

June 2, 2022

Mr. Paul Kaspar, City Engineer
City of Bryan
300 S. Texas Ave.
Bryan, TX 77803

VIA E-MAIL

RE: City of Bryan
ADJ 5309
CN600373310, RN108452137
Application No. 12-5309A to amend Certificate of Adjudication No. 12-5309
Texas Water Code §§ 11.122, 11.042, Requiring Published and Mailed Notice
Unnamed tributary of Burton Creek, Brazos River Basin
Brazos County

Dear Mr. Kaspar:

This acknowledges receipt, on April 19, 2022, of the referenced application and partial fees in the amount of \$1,109.84 (Receipt No. M216249, copy attached).

Additional information and fees are required before the application can be declared administratively complete.

1. Confirm the coordinates for the diversion point. Staff has calculated the following coordinates on the perimeter of the reservoir to be Latitude 30.641445° N and Longitude 96.363228° W as described in the certificate.
2. Confirm the coordinates for the discharge point of well #1. Staff has calculated the following coordinates on the watercourse to be Latitude 30.640942° N and Longitude 96.364730° W.
4. Before the application can be declared administratively complete, remit fees in the amount of **\$47.00**, as described below. Please make the check payable to the TCEQ or Texas Commission on Environmental Quality.

Filing Fee	(amendment)	\$	100.00
Recording Fee	(\$1.25 x 10 pages)	\$	12.50
Storage Fee	(\$1.00 x 47 acre-feet)	\$	47.00
Mailed Notice Fee	(Brazos River Basin)	\$	997.34
TOTAL FEES		\$	1,156.84
FEES RECEIVED		\$	1,109.84
TOTAL FEES DUE		\$	47.00

Please submit the requested information and fees by July 5, 2022 or the application may be returned pursuant to Title 30 Texas Administrative Code § 281.18.

City of Bryan
Application No. 12-5309A
June 2, 2022
Page 2 of 2

If you have any questions concerning this matter, please contact me via email at lillian.beerman@tceq.texas.gov or by telephone at (512) 239-4019.

Sincerely,

Lillian E. Beerman, Ph.D.

Lillian E. Beerman, Ph.D., Project Manager
Water Rights Permitting Team
Water Rights Permitting and Availability Section

Attachment



21-APR-22 09:06 AM

TCEQ - A/R RECEIPT REPORT BY ACCOUNT NUMBER

<u>Fee Description</u>	<u>Fee Code</u> <u>Account#</u> <u>Account Name</u>	<u>Ref#1</u> <u>Ref#2</u> <u>Paid In By</u>	<u>Check Number</u> <u>Card Auth.</u> <u>User Data</u>	<u>CC Type</u> <u>Tran Code</u> <u>Rec Code</u>	<u>Slip Key</u> <u>Document#</u>	<u>Tran Date</u>	<u>Tran Amount</u>
WTR USE PERMITS	WUP	M216248	1002		BS00094293	21-APR-22	-\$587.81
	WUP		042022	N	D2802529		
WATER USE PERMITS		ANNA	VACRUZ	CK			
		CROSSING					
		PARTNERSHIP					
		ACC					
	WUP	M216249	479727		BS00094293	21-APR-22	-\$1,109.84
	WUP		042022	N	D2802529		
WATER USE PERMITS		BRYAN, CITY	VACRUZ	CK			
		OF					
						Total (Fee Code):	-\$1,697.65
						Grand Total:	-\$6,604.90

RECEIVED

APR 22 2022

Water Availability Division

Re: Water Rights Permit 12 5309

Lillian Beerman <Lillian.Beerman@Tceq.Texas.Gov>

Mon 5/23/2022 12:22 PM

To: Tristen Fisher [REDACTED]

Tristen,

A Request for Information for the City of Bryan's Application No. 12-5309A to amend ADJ 5309 is in Section Review. When review is complete, I will forward you the request.

Thank You,

Lillian E. Beerman, Ph.D.
Water Rights Permitting Team
Water Availability Division
512 239 4019
lillian.beerman@tceq.texas.gov

From: Tristen Fisher [REDACTED]

Sent: Monday, May 23, 2022 11 50 AM

To: Lillian Beerman Lillian Beerman@Tceq Texas Gov

Subject: Re Water Rights Permit 12 5309

Good morning Lillian,

I hope you are doing well. Last we spoke, the initial review of the application was completed and there was some information you needed from me that you would inform me of shortly. I don't believe I received anything from you yet, but I wanted to double check seeing how it has been a few weeks since we last spoke. Are we still waiting on you to send us our next steps, or have you already sent those to me? If so, could you please send them again? I really appreciate your time!



Tristen Fisher
Graduate Engineer

[Mitchell and Morgan LLP](#)

3204 Earl Rudder Fwy. S.
College Station, Texas 77845-6457

T: [979.260.6963](tel:979.260.6963)

Providing Solutions for a Better Tomorrow...

Re: Water Rights Permit 12-5309

Tristen Fisher

Wed 5/4/2022 12:00 PM

To: Lillian Beerman <Lillian.Beerman@Tceq.Texas.Gov>

Lillian,

Thank you very much for the update. I appreciate the detailed information. We look forward to hearing from you with our next steps in the Administration Review.

Tristen Fisher
Graduate Engineer

[Mitchell and Morgan, LLP](#)
3204 Earl Rudder Fwy. S.
College Station, Texas 77845-6457
T: [979.260.6963](tel:979.260.6963)

Providing Solutions for a Better Tomorrow...

CONFIDENTIALITY NOTE

This email and any files transmitted with it contain privileged and confidential information and are intended solely for the use of the individual or entity to which they are addressed. If you are not the intended recipient or the person responsible for delivering the email to the intended recipient, you are hereby notified that any dissemination or copying of this email or any of its attachment(s) is strictly prohibited. If you have received this email in error, please immediately notify the sending individual or entity by email and permanently delete the original email and attachment(s) from your computer system.

On Wed, May 4, 2022 at 11:50 AM Lillian Beerman <Lillian.Beerman@tceq.texas.gov> wrote:

Mr. Tristin Fisher,

Thank you for your inquiry regarding the processing timeline for the City of Bryan's Application No. 12-5309A.

I am the project manager. I have completed the initial setup of the application and it is now in Administrative Review. The technical staff and I have completed the initial review of the application and will be contacting you shortly requesting information needed to complete the Administrative Process and to perform Technical Review.

Once Technical Review and water availability analysis are completed, the amendment will be drafted and reviewed, and you will have an opportunity to review the draft amendment and the technical supporting documents.

The next step is Public Notice. The City of Bryan's Application No. 12-5309A will require full basin mailed and published notice to water right holders of record in the Brazos River Basin. Assuming the application is not contested, the final step is publication of the amendment.

The goal is to complete this process in less than a year. Applications are reviewed in the order they are received in a given river basin. However, the City of Bryan's Application No. 12-5309 is on a Fast Track, it will be given priority during Technical Review.

I will be contacting you shortly requesting information needed to complete Administrative Review. Please be assured that I will keep you apprised of the progress of the application. If you have any questions or concerns, do not hesitate to contact me.

Respectfully,

Lillian E. Beerman, Ph.D.

Water Rights Permitting Team

Water Availability Division

512-239-4019

lillian.beerman@tceq.texas.gov

From: Tristen Fisher

Sent: Tuesday, May 3, 2022 3:27 PM

To: Lillian Beerman <Lillian.Beerman@Tceq.Texas.Gov>

Subject: Water Rights Permit 12-5309

Good afternoon Lillian,

Our client was curious about the timeline for the review of the permit. We understand that an uncontested application is typically processed in 300 days, but were curious if there is a hard-fast deadline that y'all set for the review process of our application and what your timeline looked like. I really appreciate your help with this.

Tristen Fisher
Graduate Engineer

[Mitchell and Morgan, LLP](#)

3204 Earl Rudder Fwy. S.
College Station, Texas 77845-6457
T: [979.260.6963](tel:979.260.6963)

Providing Solutions for a Better Tomorrow...

CONFIDENTIALITY NOTE

This email and any files transmitted with it contain privileged and confidential information and are intended solely for the use of the individual or entity to which they are addressed. If you are not the intended recipient or the person responsible for delivering the email to the intended recipient, you are hereby notified that any dissemination or copying of this email or any of its attachment(s) is strictly prohibited. If you have received this email in error, please immediately notify the sending individual or entity by email and permanently delete the original email and attachment(s) from your computer system.



TCEQ
Water Availability Division, MC-160
P.O. Box 13087
Austin, TX 78711-3087

April 11, 2022

RE: Water Rights Permit – Midtown Lake (Certificate of Adjudication #12-539)

CERTIFIED RETURN RECEIPT 7009 1410 0000 9212 2307

Dear TCEQ,

This letter is to inform you that we, Mitchell and Morgan, on behalf of the City of Bryan, have completed and enclosed the Water Rights Permit for the City of Bryan Midtown Lake for Texas Commission on Environmental Quality (TCEQ) approval. This application requests to increase the water impoundment at Midtown Lake, located in Midtown Park at the NW corner of Villa Maria Rd and South College Ave in Bryan, Texas. Enclosed you will find the complete application, along with all necessary attachments. We attended the required Pre-Application meeting via Zoom with TCEQ on December 7, 2021 and have addressed all of the comments made by TCEQ staff during that time. We have included, with this application, a check covering the required fees for this application, payable to TCEQ. Along with this hard copy submission, we will also be submitting an electronic version on the TCEQ FTP site.

Please contact us with any questions that you may have on the subject.

Thank you,

A handwritten signature in black ink, appearing to read "Veronica Morgan", is written over a horizontal line.

Veronica Morgan, PE, CFM
Managing Partner

cc: file
COB – Paul Kasper, City Engineer

**TCEQ WATER RIGHTS
PERMITTING APPLICATION**

FOR

**THE CITY OF BRYAN
CERT OF ADJ: 12-5309**

Table of Contents

Administrative Information Checklist	3
Administrative Information Report	5
Certificate of Adjudication	12
Summary of Request.....	15
City of Bryan Signature Authority.....	17
Technical Information Report	19
Addendum Regarding the State and Regional Water Plans	24
General Application Maps.....	28
Worksheet 1.0	31
Irrigation Map	34
Property Deeds.....	36
Worksheet 1.1 (N/A)	45
Worksheet 1.2 (N/A)	46
Worksheet 2.0	47
Notice to Governing Bodies	50
Consent for Inundated Land.....	53
Drainage Calculation Map	55
Dam Location Map	57
Worksheet 3.0	59
Diversion Point Map.....	62
Worksheet 4.0 – Midtown Park Well #1 (BVDO-0286)	64
Worksheet 4.0 – Midtown Park Well #2 (BVDO-0287)	66
Evaporation Calculations.....	68
Sparta Well Pump Tests	70
Groundwater Well Operating Permits	80
Worksheet 4.1 – Midtown Park Well #1 (BVDO-0286)	86
Worksheet 4.1 – Midtown Park Well #2 (BVDO-0287)	88
Discharge Points Map.....	90
Worksheet 5.0	92
Impingement and Entrainment.....	96
Assessment of Adequacy.....	98
Worksheet 6.0 (N/A)	100
Worksheet 7.0	101
Accounting Plan Text File	103
Accounting Plan Spreadsheet.....	106
Worksheet 8.0	108

1

ADMINISTRATIVE INFORMATION CHECKLIST

TEXAS COMMISSION ON ENVIRONMENTAL QUALITY

TCEQ WATER RIGHTS PERMITTING APPLICATION

ADMINISTRATIVE INFORMATION CHECKLIST

Complete and submit this checklist for each application. See Instructions Page. 5.

APPLICANT(S): CITY OF BRYAN

Indicate whether the following items are included in your application by writing either Y (for yes) or N (for no) next to each item (all items are not required for every application).

Y/N		Y/N	
<input checked="" type="checkbox"/>	Administrative Information Report	<input checked="" type="checkbox"/>	Worksheet 3.0
<input type="checkbox"/>	Additional Co-Applicant Information	<input type="checkbox"/>	Additional W.S 3.0 for each Point
<input type="checkbox"/>	Additional Co-Applicant Signature Pages	<input checked="" type="checkbox"/>	Recorded Deeds for Diversion Points
<input checked="" type="checkbox"/>	Written Evidence of Signature Authority	<input type="checkbox"/>	Consent For Diversion Access
<input checked="" type="checkbox"/>	Technical Information Report	<input checked="" type="checkbox"/>	Worksheet 4.0
<input checked="" type="checkbox"/>	USGS Map (or equivalent)	<input type="checkbox"/>	TPDES Permit(s)
<input checked="" type="checkbox"/>	Map Showing Project Details	<input type="checkbox"/>	WWTP Discharge Data
<input type="checkbox"/>	Original Photographs	<input checked="" type="checkbox"/>	24-hour Pump Test
<input type="checkbox"/>	Water Availability Analysis	<input checked="" type="checkbox"/>	Groundwater Well Permit
<input checked="" type="checkbox"/>	Worksheet 1.0	<input type="checkbox"/>	Signed Water Supply Contract
<input checked="" type="checkbox"/>	Recorded Deeds for Irrigated Land	<input checked="" type="checkbox"/>	Worksheet 4.1
<input type="checkbox"/>	Consent For Irrigation Land	<input checked="" type="checkbox"/>	Worksheet 5.0
<input type="checkbox"/>	Worksheet 1.1	<input checked="" type="checkbox"/>	Addendum to Worksheet 5.0
<input type="checkbox"/>	Addendum to Worksheet 1.1	<input type="checkbox"/>	Worksheet 6.0
<input type="checkbox"/>	Worksheet 1.2	<input type="checkbox"/>	Water Conservation Plan(s)
<input type="checkbox"/>	Addendum to Worksheet 1.2	<input type="checkbox"/>	Drought Contingency Plan(s)
<input checked="" type="checkbox"/>	Worksheet 2.0	<input type="checkbox"/>	Documentation of Adoption
<input type="checkbox"/>	Additional W.S 2.0 for Each Reservoir	<input checked="" type="checkbox"/>	Worksheet 7.0
<input checked="" type="checkbox"/>	Dam Safety Documents	<input checked="" type="checkbox"/>	Accounting Plan
<input checked="" type="checkbox"/>	Notice(s) to Governing Bodies	<input checked="" type="checkbox"/>	Worksheet 8.0
<input checked="" type="checkbox"/>	Recorded Deeds for Inundated Land	<input checked="" type="checkbox"/>	Fees
<input checked="" type="checkbox"/>	Consent For Inundation Land		

For Commission Use Only:

Proposed/Current Water Right Number: _____

Basin: _____ Watermaster area Y/N: _____

2

ADMINISTRATIVE INFORMATION REPORT

ADMINISTRATIVE INFORMATION REPORT

The following information is required for all new applications and amendments.

***** Applicants are strongly encouraged to schedule a pre-application meeting with TCEQ Staff to discuss Applicant's needs prior to submitting an application. Call the Water Rights Permitting Team to schedule a meeting at (512) 239-4691.**

1. TYPE OF APPLICATION (Instructions, Page. 6)

Indicate, by marking X, next to the following authorizations you are seeking.

New Appropriation of State Water

Amendment to a Water Right *

Bed and Banks

****If you are seeking an amendment to an existing water rights authorization, you must be the owner of record of the authorization. If the name of the Applicant in Section 2, does not match the name of the current owner(s) of record for the permit or certificate or if any of the co-owners is not included as an applicant in this amendment request, your application could be returned. If you or a co-applicant are a new owner, but ownership is not reflected in the records of the TCEQ, submit a change of ownership request (Form TCEQ-10204) prior to submitting the application for an amendment. See Instructions page. 6. Please note that an amendment application may be returned, and the Applicant may resubmit once the change of ownership is complete.***

Please summarize the authorizations or amendments you are seeking in the space below or attach a narrative description entitled "Summary of Request."

The Summary of Request is attached on page 16.

2. APPLICANT INFORMATION (Instructions, Page. 6)

a. Applicant

Indicate the number of Applicants/Co-Applicants 1
(Include a copy of this section for each Co-Applicant, if any)

What is the Full Legal Name of the individual or entity (applicant) applying for this permit?

City of Bryan, Texas

(If the Applicant is an entity, the legal name must be spelled exactly as filed with the Texas Secretary of State, County, or in the legal documents forming the entity.)

If the applicant is currently a customer with the TCEQ, what is the Customer Number (CN)?

You may search for your CN on the TCEQ website at

<http://www15.tceq.texas.gov/crpub/index.cfm?fuseaction=cust.CustSearch>

CN : CN600373310 (leave blank if you do not yet have a CN).

What is the name and title of the person or persons signing the application? Unless an application is signed by an individual applicant, the person or persons must submit written evidence that they meet the signatory requirements in 30 TAC § 295.14.

First/Last Name: **Kean Register**

Title: **City Manager**

Have you provided written evidence meeting the signatory requirements in 30 TAC § 295.14, as an attachment to this application? **YES**

What is the applicant's mailing address as recognized by the US Postal Service (USPS)? You may verify the address on the USPS website at

<https://tools.usps.com/go/ZipLookupAction!input.action>.

Name: **City of Bryan, City Mgr**

Mailing Address: **300 S Texas Avenue**

City: **Bryan**

State: **Texas**

ZIP Code:

Indicate an X next to the type of Applicant:

Individual

Sole Proprietorship-D.B.A.

Partnership

Corporation

Trust

Estate

Federal Government

State Government

County Government

City Government

Other Government

Other _____

For Corporations or Limited Partnerships, provide:

State Franchise Tax ID Number: N/A SOS Charter (filing) Number: N/A

3. APPLICATION CONTACT INFORMATION (Instructions, Page. 9)

If the TCEQ needs additional information during the review of the application, who should be contacted? Applicant may submit their own contact information if Applicant wishes to be the point of contact.

First and Last Name: Paul Kaspar, PE

Title: City Engineer

Organization Name: City of Bryan

Mailing Address: 300 S Texas Avenue

City: Bryan

State: Texas

ZIP Code: 77803

Phone No.: 979-209-5030

Extension:

Fax No.: 979-209-5035

E-mail Address: 

**4. WATER RIGHT CONSOLIDATED CONTACT INFORMATION
(Instructions, Page. 9)**

This section applies only if there are multiple Owners of the same authorization. Unless otherwise requested, Co-Owners will each receive future correspondence from the Commission regarding this water right (after a permit has been issued), such as notices and water use reports. Multiple copies will be sent to the same address if Co-Owners share the same address. Complete this section if there will be multiple owners and **all** owners agree to let one owner receive correspondence from the Commission. Leave this section blank if you would like all future notices to be sent to the address of each of the applicants listed in section 2 above.

I/We authorize all future notices be received on my/our behalf at the following:

First and Last Name: N/A

Title:

Organization Name:

Mailing Address:

City:

State:

ZIP Code:

Phone No.:

Extension:

Fax No.:

E-mail Address:

5. MISCELLANEOUS INFORMATION (Instructions, Page. 9)

a. The application will not be processed unless all delinquent fees and/or penalties owed to the TCEQ or the Office of the Attorney General on behalf of the TCEQ are paid in accordance with the Delinquent Fee and Penalty Protocol by all applicants/co-applicants. If you need assistance determining whether you owe delinquent penalties or fees, please call the Water Rights Permitting Team at (512) 239-4691, prior to submitting your application.

1. Does Applicant or Co-Applicant owe any fees to the TCEQ? **Yes / No NO**

If **yes**, provide the following information:

Account number:

Amount past due:

2. Does Applicant or Co-Applicant owe any penalties to the TCEQ? **Yes / No NO**

If **yes**, please provide the following information:

Enforcement order number:

Amount past due:

b. If the Applicant is a taxable entity (corporation or limited partnership), the Applicant must be in good standing with the Comptroller or the right of the entity to transact business in the State may be forfeited. See Texas Tax Code, Subchapter F. Applicant's may check their status with the Comptroller at <https://mycpa.cpa.state.tx.us/coa/>

Is the Applicant or Co-Applicant in good standing with the Comptroller? **Yes / No N/A**

c. The commission will not grant an application for a water right unless the applicant has submitted all Texas Water Development Board (TWDB) surveys of groundwater and surface water use - if required. See TWC §16.012(m) and 30 TAC § 297.41(a)(5).

Applicant has submitted all required TWDB surveys of groundwater and surface water? **Yes / No YES**

6. SIGNATURE PAGE (Instructions, Page. 11)

Applicant:

I, Kean Register

City Manager

(Typed or printed name)

(Title)

certify under penalty of law that this document and all attachments were prepared under my direction or supervision in accordance with a system designed to assure that qualified personnel properly gather and evaluate the information submitted. Based on my inquiry of the person or persons who manage the system, or those persons directly responsible for gathering the information, the information submitted is, to the best of my knowledge and belief, true, accurate, and complete. I am aware there are significant penalties for submitting false information, including the possibility of fine and imprisonment for knowing violations.

I further certify that I am authorized under Title 30 Texas Administrative Code §295.14 to sign and submit this document and I have submitted written evidence of my signature authority.

Signature: *Kean Register*

Date: 4/05/2022

(Use blue ink)

Subscribed and Sworn to before me by the said

on this 5th day of April, 2022.

My commission expires on the 19th day of February, 2023.

Notary Public

[Handwritten Signature]

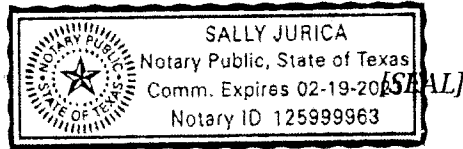

County, Texas

If the Application includes Co-Applicants, each Applicant and Co-Applicant must submit an original, separate signature page

**CERTIFICATE OF ADJUDICATION
12-5309**

CERTIFICATE OF ADJUDICATION

CERTIFICATE OF ADJUDICATION: 12-5309

OWNER: City of Bryan
P. O. Box 1000
Bryan, Texas 77801

COUNTY: Brazos

PRIORITY DATE: January 6, 1975

WATERCOURSE: unnamed tributary of
Burton Creek, tributary
of Carters Creek,
tributary of the Navasota
River, tributary of the
Brazos River

BASIN: Brazos River

WHEREAS, by final decree of the 21st Judicial District Court of Bastrop County, in Cause No. 18,762, In Re: The Adjudication of Water Rights in the Brazos IV Segment of the Brazos River Basin and the San Jacinto-Brazos Coastal Basin dated June 1, 1987 a right was recognized under Permit 3045 authorizing the City of Bryan to appropriate waters of the State of Texas as set forth below:

NOW, THEREFORE, this certificate of adjudication to appropriate waters of the State of Texas in the Brazos River Basin is issued to the City of Bryan, subject to the following terms and conditions:

1. IMPOUNDMENT

Owner is authorized to maintain an existing dam and reservoir on an unnamed tributary of Burton Creek (Country Club Lake) and impound therein not to exceed 73 acre-feet of water. The dam is located in the Zeno Phillips Grant, Abstract 45, Brazos County, Texas.

2. USE

Owner is authorized to use the water impounded in the aforesaid reservoir for recreation purposes with no right of diversion.

3. PRIORITY

The time priority of owner's right is January 6, 1975.

4. SPECIAL CONDITION

Owner shall maintain a suitable outlet in the aforesaid dam authorized herein to allow the free passage of water that owner is not entitled to impound.

The location of pertinent features related to this certificate are shown on Page 2 of the Brazos IV River Segment Certificates of Adjudication Maps,

Certificate of Adjudication 12-5309

copies of which are located in the office of the Texas Water Commission, Austin, Texas.

This certificate of adjudication is issued subject to all terms, conditions and provisions in the final decree of the 21st Judicial District Court of Bastrop County, Texas, in Cause No. 18,762, In Re: The Adjudication of Water Rights in the Brazos IV Segment of the Brazos River Basin and the San Jacinto-Brazos Coastal Basin dated June 1, 1987 and supersedes all rights of the owner asserted in that cause.

This certificate of adjudication is issued subject to senior and superior water rights in the Brazos River Basin.

This certificate of adjudication is issued subject to the Rules of the Texas Water Commission and its continuing right of supervision of State water resources consistent with the public policy of the State as set forth in the Texas Water Code.

TEXAS WATER COMMISSION

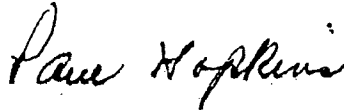

Paul Hopkins, Chairman

DATE ISSUED:

JAN 14 1988

ATTEST:

Karen A. Phillips, Chief Clerk

SUMMARY OF REQUEST



TCEQ Water Rights

Administrative Report

Summary of Request

The City of Bryan is requesting to increase its water impoundment on the unnamed tributary of Burton Creek (Midtown Lake, formerly known as Country Club Lake) from the current 73 acre-feet, authorized by certificate of adjudication 12-5309, to 120 acre-feet. Two groundwater wells have been permitted by the Brazos Valley Groundwater Conservation District (BVGCD) to be constructed on-site to produce 250 acre-feet/year each, for a total of 500 acre-feet/year. The City of Bryan intends to utilize privately owned groundwater from these wells to supplement its currently authorized impoundment of 73 acre-feet of state water and to maintain the requested impoundment of 120 acre-feet at a constant level. These on-site wells will discharge into an unnamed tributary of Burton Creek and the groundwater will be carried through the bed and banks of this channel to the lake. The lake will be used for recreational activities such as fishing and canoeing, while also providing an amenity to Midtown Park. The groundwater from the wells will be used to maintain the 120-acre feet of storage as well as a portion will be diverted out of Midtown Lake to be used for irrigation within portions of the adjacent Travis Bryan Midtown Park.

**CITY OF BRYAN
SIGNATURE
AUTHORITY**

RESOLUTION NO. 3967

A RESOLUTION OF THE CITY COUNCIL OF THE CITY OF BRYAN, TEXAS, AUTHORIZING THE CITY MANAGER TO EXECUTE ALL DOCUMENTS ASSOCIATED WITH THE GOAL OF INCREASING THE AMOUNT OF WATER IMPOUNDED BY THE COUNTRY CLUB LAKE (TRAVIS BRYAN MIDTOWN LAKE), INCLUDING ADMINISTRATIVE INFORMATION REPORTS REQUIRED AS PART OF THE PERMIT PROCESS WITH THE STATE OF TEXAS (TEXAS COMMISSION ON ENVIRONMENTAL QUALITY – TCEQ).

WHEREAS, the Texas Commission on Environmental Quality (TCEQ) regulates the amount of water permitted to be impounded by the Country Club Lake reservoir; and

WHEREAS, the City of Bryan is proposing to increase the amount of water stored in the lake as part of the Travis Bryan Midtown Park redevelopment project; and

WHEREAS, project costs will be funded from existing bond funds or future bond funds; and

WHEREAS, the Travis Bryan Midtown Park redevelopment is on the Capital Improvement Program for the City of Bryan;

NOW, THEREFORE, BE IT RESOLVED by the City Council of the City of Bryan, Texas that:

1.

The matters set forth in the preamble are true and correct and incorporated as if fully set forth herein.

2.

The City Council supports increasing the amount of water stored in the Country Club Lake and authorizes the City Manager (in accordance with 30 TAC 295.14 of the Texas Administrative Code) to sign all paperwork associated with that goal including any permitting with the State of Texas.

3.

This Resolution shall be effective immediately upon its adoption.

APPROVED AND ADOPTED by the City Council of the City of Bryan this 14th day of December, 2021.

ATTEST:

CITY OF BRYAN:

Mary L. Stratta

Andrew Nelson

Mary Lynne Stratta, City Secretary

Andrew Nelson, Mayor

APPROVED AS TO FORM:

Thomas A. Leeper

Thomas A. Leeper, Interim City Attorney



3

TECHNICAL INFORMATION REPORT

TECHNICAL INFORMATION REPORT

WATER RIGHTS PERMITTING

This Report is required for applications for new or amended water rights. Based on the Applicant's responses below, Applicant are directed to submit additional Worksheets (provided herein). A completed Administrative Information Report is also required for each application.

Applicants are strongly encouraged to schedule a pre-application meeting with TCEQ Permitting Staff to discuss Applicant's needs and to confirm information necessary for an application prior to submitting such application. Please call Water Availability Division at (512) 239-4600 to schedule a meeting. Applicant attended a pre-application meeting with TCEQ Staff for this Application? Y / N YES (If yes, date : 12-7-2021).

1. New or Additional Appropriations of State Water. Texas Water Code (TWC) § 11.121 (Instructions, Page. 12)

State Water is: *The water of the ordinary flow, underflow, and tides of every flowing river, natural stream, and lake, and of every bay or arm of the Gulf of Mexico, and the storm water, floodwater, and rainwater of every river, natural stream, canyon, ravine, depression, and watershed in the state. TWC § 11.021.*

- a. Applicant requests a new appropriation (diversion or impoundment) of State Water? Y / N NO
- b. Applicant requests an amendment to an existing water right requesting an increase in the appropriation of State Water or an increase of the overall or maximum combined diversion rate? Y / N NO (If yes, indicate the Certificate or Permit number: 12-5309)

If Applicant answered yes to (a) or (b) above, does Applicant also wish to be considered for a term permit pursuant to TWC § 11.1381? Y / N NO

- c. Applicant requests to extend an existing Term authorization or to make the right permanent? Y / N NO (If yes, indicate the Term Certificate or Permit number: 12-5309)

If Applicant answered yes to (a), (b) or (c), the following worksheets and documents are required:

- **Worksheet 1.0 – Quantity, Purpose, and Place of Use Information Worksheet**
- **Worksheet 2.0 - Impoundment/Dam Information Worksheet** (submit one worksheet for each impoundment or reservoir requested in the application)
- **Worksheet 3.0 - Diversion Point Information Worksheet** (submit one worksheet for each diversion point and/or one worksheet for the upstream limit and one worksheet for the downstream limit of each diversion reach requested in the application)
- **Worksheet 5.0 – Environmental Information Worksheet**
- **Worksheet 6.0 – Water Conservation Information Worksheet**
- **Worksheet 7.0 – Accounting Plan Information Worksheet**
- **Worksheet 8.0 – Calculation of Fees**
- **Fees calculated on Worksheet 8.0 – see instructions Page. 34.**
- **Maps – See instructions Page. 15.**
- **Photographs - See instructions Page. 30.**

Additionally, if Applicant wishes to submit an alternate source of water for the project/authorization, see Section 3, Page 3 for Bed and Banks Authorizations (Alternate sources may include groundwater, imported water, contract water or other sources).

Additional Documents and Worksheets may be required (see within).

2. Amendments to Water Rights. TWC § 11.122 (Instructions, Page. 12)

This section should be completed if Applicant owns an existing water right and Applicant requests to amend the water right. *If Applicant is not currently the Owner of Record in the TCEQ Records, Applicant must submit a Change of Ownership Application (TCEQ-10204) prior to submitting the amendment Application or provide consent from the current owner to make the requested amendment. If the application does not contain consent from the current owner to make the requested amendment, TCEQ will not begin processing the amendment application until the Change of Ownership has been completed and will consider the Received Date for the application to be the date the Change of Ownership is completed. See instructions page. 6.*

Water Right (Certificate or Permit) number you are requesting to amend: 12-5309

Applicant requests to sever and combine existing water rights from one or more Permits or Certificates into another Permit or Certificate? Y / N NO (if yes, complete chart below):

List of water rights to sever	Combine into this ONE water right
N/A	N/A

a. Applicant requests an amendment to an existing water right to increase the amount of the appropriation of State Water (diversion and/or impoundment)? Y / N NO

If yes, application is a new appropriation for the increased amount, complete Section 1 of this Report (PAGE. 1) regarding New or Additional Appropriations of State Water.

b. Applicant requests to amend existing Term authorization to extend the term or make the water right permanent (remove conditions restricting water right to a term of years)? Y / N NO

If yes, application is a new appropriation for the entire amount, complete Section 1 of this Report (PAGE. 1) regarding New or Additional Appropriations of State Water.

c. Applicant requests an amendment to change the purpose or place of use or to add an additional purpose or place of use to an existing Permit or Certificate? Y / N NO

If yes, submit:

- **Worksheet 1.0 - Quantity, Purpose, and Place of Use Information Worksheet**
- **Worksheet 1.2 - Notice: "Marshall Criteria"**

d. Applicant requests to change: diversion point(s); or reach(es); or diversion rate? Y / N NO

If yes, submit:

- **Worksheet 3.0 - Diversion Point Information Worksheet** (submit one worksheet for each diversion point or one worksheet for the upstream limit and one worksheet for the downstream limit of each diversion reach)
- **Worksheet 5.0 - Environmental Information** (Required for any new diversion points that are not already authorized in a water right)

e. Applicant requests amendment to add or modify an impoundment, reservoir, or dam? Y / N YES

If yes, submit: Worksheet 2.0 - Impoundment/Dam Information Worksheet (submit one worksheet for each impoundment or reservoir)

- f. Other - Applicant requests to change any provision of an authorization not mentioned above? Y / N N/A *If yes, call the Water Availability Division at (512) 239-4600 to discuss.*

Additionally, all amendments require:

- **Worksheet 8.0 - Calculation of Fees; and Fees calculated - see instructions Page. 34**
- **Maps - See instructions Page. 15.**
- **Additional Documents and Worksheets may be required (see within).**

3. Bed and Banks. TWC § 11.042 (Instructions, Page 13)

- a. Pursuant to contract, Applicant requests authorization to convey, stored or conserved water to the place of use or diversion point of purchaser(s) using the bed and banks of a watercourse? TWC § 11.042(a). Y/N NO

If yes, submit a signed copy of the Water Supply Contract pursuant to 30 TAC §§ 295.101 and 297.101. Further, if the underlying Permit or Authorization upon which the Contract is based does not authorize Purchaser's requested Quantity, Purpose or Place of Use, or Purchaser's diversion point(s), then either:

- 1. Purchaser must submit the worksheets required under Section 1 above with the Contract Water identified as an alternate source; or*
- 2. Seller must amend its underlying water right under Section 2.*

- b. Applicant requests to convey water imported into the state from a source located wholly outside the state using the bed and banks of a watercourse? TWC § 11.042(a-1). Y / N NO

If yes, submit: worksheets 1.0, 2.0, 3.0, 4.0, 5.0, 7.0, 8.0, Maps and fees from the list below.

- c. Applicant requests to convey Applicant's own return flows derived from privately owned groundwater using the bed and banks of a watercourse? TWC § 11.042(b). Y / N NO

If yes, submit: worksheets 1.0, 2.0, 3.0, 4.0, 5.0, 7.0, 8.0, Maps, and fees from the list below.

- d. Applicant requests to convey Applicant's own return flows derived from surface water using the bed and banks of a watercourse? TWC § 11.042(c). Y / N NO

If yes, submit: worksheets 1.0, 2.0, 3.0, 4.0, 5.0, 6.0, 7.0, 8.0, Maps, and fees from the list below.

****Please note, if Applicant requests the reuse of return flows belonging to others, the Applicant will need to submit the worksheets and documents under Section 1 above, as the application will be treated as a new appropriation subject to termination upon direct or indirect reuse by the return flow discharger/owner.***

- e. Applicant requests to convey water from any other source, other than (a)-(d) above, using the bed and banks of a watercourse? TWC § 11.042(c). Y / N YES

If yes, submit: worksheets 1.0, 2.0, 3.0, 4.0, 5.0, 7.0, 8.0, Maps, and fees from the list below.

Worksheets and information:

- **Worksheet 1.0 - Quantity, Purpose, and Place of Use Information Worksheet**
- **Worksheet 2.0 - Impoundment/Dam Information Worksheet** (submit one worksheet for each impoundment or reservoir owned by the applicant through which water will be conveyed or diverted)
- **Worksheet 3.0 - Diversion Point Information Worksheet** (submit one worksheet for the downstream limit of each diversion reach for the proposed conveyances)
- **Worksheet 4.0 - Discharge Information Worksheet** (for each discharge point)

- Worksheet 5.0 – Environmental Information Worksheet
- Worksheet 6.0 – Water Conservation Information Worksheet
- Worksheet 7.0 – Accounting Plan Information Worksheet
- Worksheet 8.0 – Calculation of Fees; and Fees calculated – see instructions Page. 34
- Maps – See instructions Page. 15.
- Additional Documents and Worksheets may be required (see within).

4. General Information, Response Required for all Water Right Applications (Instructions, Page 15)

- a. Provide information describing how this application addresses a water supply need in a manner that is consistent with the state water plan or the applicable approved regional water plan for any area in which the proposed appropriation is located or, in the alternative, describe conditions that warrant a waiver of this requirement (*not required for applications to use groundwater-based return flows*). Include citations or page numbers for the State and Regional Water Plans, if applicable. Provide the information in the space below or submit a supplemental sheet entitled “Addendum Regarding the State and Regional Water Plans”:

See attached document on pg.25

- b. Did the Applicant perform its own Water Availability Analysis? Y / N NO

If the Applicant performed its own Water Availability Analysis, provide electronic copies of any modeling files and reports.

- c. Does the application include required Maps? (Instructions Page. 15) Y / N YES

**TECHNICAL INFORMATION REPORT
ATTACHMENTS:**

**ADDENDUM REGARDING
THE STATE AND REGIONAL WATER PLANS**



TCEQ Water Rights

Technical Information Report

Addendum Regarding the State and Regional Water Plans

The City of Bryan's Midtown Lake project is located within Groundwater Management Area 12 in the Brazos G Water Planning Group. The application is consistent with both the 2022 State Water Plan and the 2021 Brazos Regional Water Plan, containing no conflicts with either plan.

The application's requested appropriation and well design yield both fall into the Regional Plan's groundwater availability. According to Table 3-10 on page 3-61 of the 2021 Brazos G Regional Water Plan¹, the portion of the Sparta aquifer available in Brazos County had groundwater availability of 5,404 acre-feet/year in the year 2020. This number will climb to 6,505 acre-feet/year by the year 2030. The application's request for 500 acre-feet falls comfortably below the water availability threshold. Along with this, typical wells out of the Sparta aquifer yield between 200 and 600 gpm, as shown in Table 3-11 on page 3-66. The application's request for two wells yielding a maximum of 250 gpm each fits within these parameters.

¹ Brazos River Authority (October 2020). "2021 Brazos G Regional Water Plan." Retrieved from: <http://www.brazosgwater.org/2021-Water-Plan.aspx>

Table 3-10. Groundwater Availability Used in the 2021 Brazos G Regional Water Plan

County	Aquifer	Availability (acre-feet/year)					
		2020	2030	2040	2050	2060	2070
Bell	Edwards-BFZ (N. Segment)	6,469	6,469	6,469	6,469	6,469	6,469
	Trinity	9,267	9,241	9,267	9,241	9,267	9,241
	Subtotal	15,736	15,710	15,736	15,710	15,736	15,710
Bosque	Brazos River Alluvium ^A	830	830	830	830	830	830
	Trinity	8,788	8,762	8,788	8,762	8,788	8,762
	Subtotal	9,618	9,592	9,618	9,592	9,618	9,592
Brazos	Brazos River Alluvium	81,581	80,311	80,081	79,976	79,913	79,872
	Carrizo-Wilcox	44,832	47,844	49,418	53,969	57,167	57,167
	Carrizo-Wilcox (MAG Peak Factor)	53,350	55,977	59,302	63,683	65,742	65,742
	Gulf Coast ^A	1,189	1,189	1,189	1,189	1,189	1,189
	Queen City	836	883	887	891	891	891
	Sparta	5,404	6,505	7,507	8,509	8,509	8,509
	Yegua-Jackson	6,856	6,854	6,854	6,854	6,854	6,854
Subtotal ^B	149,216	151,719	155,820	161,102	163,098	163,057	
Burleson	Brazos River Alluvium	28,472	28,418	28,414	28,414	28,414	28,413
	Carrizo-Wilcox	23,242	28,039	32,511	36,485	38,694	38,694
	Queen City	416	447	447	447	447	447
	Sparta	2,246	4,042	5,613	6,735	6,735	6,735
	Yegua-Jackson	14,544	12,576	12,564	12,478	12,326	12,326
Subtotal	68,920	73,522	79,549	84,559	86,616	86,615	
Callahan	Trinity	1,729	1,725	1,729	1,725	1,729	1,725
	Subtotal	1,729	1,725	1,729	1,725	1,729	1,725
Comanche	Trinity	12,072	12,039	12,072	12,039	12,072	12,039
	Subtotal	12,072	12,039	12,072	12,039	12,072	12,039
Coryell	Trinity	4,503	4,491	4,503	4,491	4,503	4,491
	Subtotal	4,503	4,491	4,503	4,491	4,503	4,491

Table 3-11. Groundwater Availability from the Brazos G Area Aquifers

Aquifer	2070 Groundwater Availability (acft/yr)	Typical Range in Well Yields (gpm)
Western Area		
Blaine	4,400	less than 25
Cross Timbers	1,495	5 to 300
Dockum	7,388	100 to 400
Edwards-Trinity (Plateau)	1,029	5 to 300
Ogallala and Edwards Trinity- High Plains	3	
Other (Local) Aquifers	80	5 to 300
Seymour	74,848	100 to 1,000
Trinity	26	50 to 500
Subtotal:	89,269	
Central Area		
Brazos River Alluvium	15,333	250 to 500
Carrizo-Wilcox	5,620	100 to 3,000
Edwards-BFZ (Northern Segment)	7,269	200 to 2,000
Ellenburger-San Saba	129	Unknown
Gulf Coast	201	300 to 800
Marble Falls	23	less than 100
Other (Local) Aquifers	524	5 to 300
Trinity	99,163	50 to 500
Woodbine	948	50 to 150
Subtotal:	129,210	
Eastern Area		
Brazos River Alluvium	129,906	250 to 500
Carrizo-Wilcox	123,808	100 to 3,000
Gulf Coast	10,097	300 to 800
Queen City	1,689	200 to 500
Sparta	8,810	200 to 600
Navasota River Alluvium	58	Unknown

**TECHNICAL INFORMATION REPORT
ATTACHMENTS:
SECTION 5 GENERAL APPLICATION MAPS**

4

WORKSHEET 1.0

WORKSHEET 1.0

Quantity, Purpose and Place of Use

1. New Authorizations (Instructions, Page. 16)

Submit the following information regarding quantity, purpose and place of use for requests for new or additional appropriations of State Water or Bed and Banks authorizations:

Quantity (acre- feet) <i>(Include losses for Bed and Banks)</i>	State Water Source (River Basin) or Alternate Source <i>*each alternate source (and new appropriation based on return flows of others) also requires completion of Worksheet 4.0</i>	Purpose(s) of Use	Place(s) of Use <i>*requests to move state water out of basin also require completion of Worksheet 1.1 Interbasin Transfer</i>
500	Groundwater from Sparta Aquifer	Irrigation/Recreation	Brazos
47	Burton Creek	Recreation	Brazos

547 Total amount of water (in acre-feet) to be used annually (*include losses for Bed and Banks applications*)

If the Purpose of Use is Agricultural/Irrigation for any amount of water, provide:

a. Location Information Regarding the Lands to be Irrigated

i) Applicant proposes to irrigate a total of 32.5 acres in any one year. This acreage is all of or part of a larger tract(s) which is described in a supplement attached to this application and contains a total of 147.84 acres in BRAZOS County, TX.

ii) Location of land to be irrigated: In the Country Club Lake Addition Original Survey No. , Abstract No. Block 1, Lot 1 (part of) and Lot 2.

A copy of the deed(s) or other acceptable instrument describing the overall tract(s) with the recording information from the county records must be submitted. Applicant's name must match deeds.

If the Applicant is not currently the sole owner of the lands to be irrigated, Applicant must submit documentation evidencing consent or other documentation supporting Applicant's right to use the land described.

Water Rights for Irrigation may be appurtenant to the land irrigated and convey with the land unless reserved in the conveyance. 30 TAC § 297.81.

2. Amendments - Purpose or Place of Use (Instructions, Page. 12)

a. Complete this section for each requested amendment changing, adding, or removing Purpose(s) or Place(s) of Use, complete the following:

Quantity (acre-feet)	Existing Purpose(s) of Use	Proposed Purpose(s) of Use*	Existing Place(s) of Use	Proposed Place(s) of Use**
N/A				

**If the request is to add additional purpose(s) of use, include the existing and new purposes of use under "Proposed Purpose(s) of Use."*

***If the request is to add additional place(s) of use, include the existing and new places of use under "Proposed Place(s) of Use."*

Changes to the purpose of use in the Rio Grande Basin may require conversion. 30 TAC § 303.43.

b. For any request which adds Agricultural purpose of use or changes the place of use for Agricultural rights, provide the following location information regarding the lands to be irrigated:

i. Applicant proposes to irrigate a total of N/A acres in any one year. This acreage is all of or part of a larger tract(s) which is described in a supplement attached to this application and contains a total of N/A acres in N/A County, TX.

ii. Location of land to be irrigated: In the _____ Original Survey No. _____, Abstract No. Block 1, Lot 1 (part of) and Lot 2.

A copy of the deed(s) describing the overall tract(s) with the recording information from the county records must be submitted. Applicant's name must match deeds. If the Applicant is not currently the sole owner of the lands to be irrigated, Applicant must submit documentation evidencing consent or other legal right for Applicant to use the land described.

Water Rights for Irrigation may be appurtenant to the land irrigated and convey with the land unless reserved in the conveyance. 30 TAC § 297.81.

c. Submit Worksheet 1.1, Interbasin Transfers, for any request to change the place of use which moves State Water to another river basin.

d. See Worksheet 1.2, Marshall Criteria, and submit if required.

e. See Worksheet 6.0, Water Conservation/Drought Contingency, and submit if required.

**SUPPLEMENT TO
WORKSHEET 1.0**

**IRRIGATION
MAP**

PROJECT BENCHMARK:

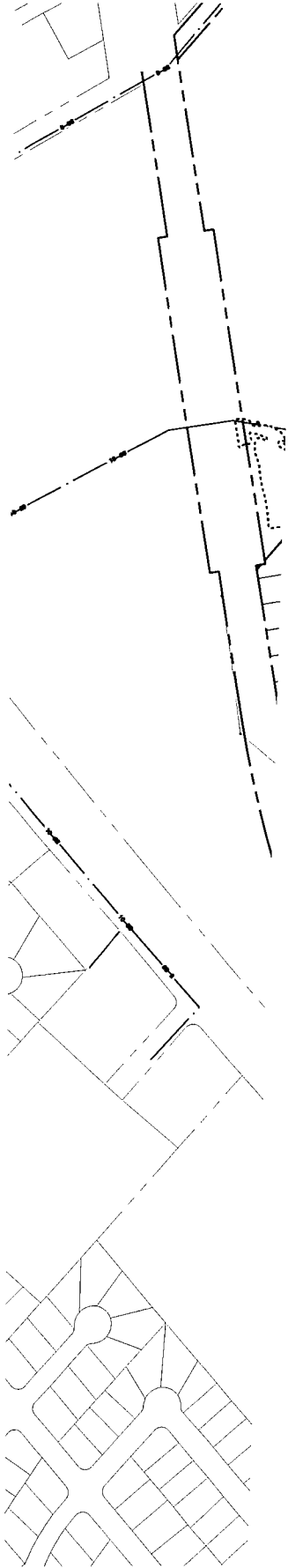

LEGEND

	Normal Pool Lake Elev= 305.00
	100 Year Floodplain
	Waters of the US (WOTUS)
	Interim Lake Edge (Elev=303.3)
	Required Spacing of Well from Property Line
	Required Spacing of Well from another Well
	Proposed Irrigated Areas
	Future Lake
	Greenbelt Reserve Area



T.979.260.6963
F.979.260.3564
TX. FIRM # F-1443

3204 EARL RUDDER Fwy. S.
COLLEGE STATION, TX 77845

PLAN & DESIGN SPECIALISTS IN
CIVIL ENGINEERING HYDRAULICS
HYDROLOGY UTILITIES STREETS
SITE PLANS SUBDIVISIONS

www.mitchellandmorgan.com

For Return Review Only
Not to be used for construction
without approval of Mitchell & Morgan, P.E.
July 12, 2021

JULY, 2021

NOVEMBER, 2021
Designed By: JAM
Drawn By: SB
Checked By: NBM

Prepared For:
Engineering Services
City of Bryan
P.O. Box 1000
Bryan, Texas 77805

Revisions

PROPOSED WATER WELL LOCATIONS

MIDTOWN PARK

EX1

**SUPPLEMENT TO
WORKSHEET 1.0
PROPERTY DEEDS**



VIA EMAIL

November 8, 2021

Tristen Fisher
Mitchell and Morgan
3204 Earl Rudder Fwy
College Station, Texas 77845
[REDACTED]

Dear Ms. Fisher:

This letter is in response to a request for information received by the City of Bryan on November 8, 2021, which asks for a copy of the following:

“the full deed documents with recording information for the two tracts of land in process of a Water Rights Permitting Application. The property ID's are:

**Property ID: 101898
Property ID: 101897**

Date Range: Jan. 6, 1998 - Jan. 16, 1998.”

Please find attached the records responsive to your request.

We now consider this request closed.

Sincerely,

Becky M. Aldridge
Records Management Coordinator

Enclosures

P.O. Box 1000, Bryan, Texas 77805 | 979.209.5000 | bryantx.gov

The State of Texas,
County of BRAZOS

Know all Men by These Presents:

That we, H. H. Williamson and wife Mrs. Pearl Williamson,

of the County of Brazos State of Texas for and in consideration
of the sum of

FORTY NINE HUNDRED SIXTY SIX AND NO/100 DOLLARS

to us ~~secured~~ secured to be paid, by The City of Bryan, a Municipal Corporation
of Brazos County, Texas, as follows:

The execution and delivery of one note for \$4966.00, of even date herewith, payable to H. H. Williamson, or order, at Bryan, Texas, payable in seven (7) installments of \$600.00 each, and one final installment of \$766.00, the first installment due and payable on or before January 1, 1941, and a like installment due and payable on or before the 1st day of each succeeding January thereafter until the whole principal sum of said note is paid. Said note bears four per cent interest from date, the interest payable annually, all past due interest to bear four per cent interest, and said note provides for accelerated maturity and for a ten per cent collection fee if default is made in the payment of same or any part thereof.

49.266

As part of the consideration for this deed, it is specially agreed that the dairy barn located on the first tract hereinafter described, may be removed by the grantors herein and title to said barn is not conveyed by this instrument.

have Granted, Sold and Conveyed, and by these presents do Grant, Sell and Convey, unto the said

The City of Bryan, a Municipal Corporation, of Brazos County, Texas,

of the County of Brazos State of Texas

All those certain tracts or parcels of land, lying and being situated in Brazos County, Texas, and described as follows:-

FIRST TRACT: All that certain tract or plot of land being situated in the Zeno Phillips League, Brazos County, Texas, and being more fully described as follows:-

BEGINNING at a point 25' north of the souther most corner of Lot No. 33, of the Evans Park Addition to the City of Bryan, which point is the mid-point of the southwest boundary of said Lot No. 33;
THENCE running S. 50 22 W. 987.65 feet, said line being center of proposed fifty foot street, and corner a stake;

THENCE S. 45 W. 1,324.2 feet, said line being center of proposed 50 foot street; and corner a stake in the east fence of the I. & G. N. R. R. Company right of way;

THENCE following I. & G. N. R. R. Company right of way fence a distance of 1,307.4 feet and corner a stake in said right of way fence, which stake is the south corner of the Robert Ellis, 25 acre tract;

THENCE N. 45 E. along the southeast line of the said 25 acre tract 1,647.35 feet and corner a stake, which stake is the east corner of said 25 acre tract;
 THENCE N. 45 W. a distance of 705.6 feet and corner a stake in the northwest boundary line of the R. Ellis original 50 acre tract, said stake being also the north corner of said 25 acre tract;
 THENCE N. 45 E. 1078.7 feet and corner a stake in said N. W. boundary line, which stake is also the south corner of Lot No. 40 of the Evans Park Addition;
 THENCE N. 31-1/2 W. along south west line of the said Evans Park Addition a distance of 375 feet to the place of beginning, the above tract containing (24.8 and 24.6) 49.4 acres of land, more or less.

SECOND TRACT: All that plot or tract of land being situated in the Zeno Phillips League, Brazos County, Texas, also in the Evans Park Addition to the City of Bryan, and being more fully described as follows:

BEGINNING at the south corner of Lot No. 40 of the Evans Park Addition to the City of Bryan, Brazos County, Texas;
 THENCE running N. 45 E. 63.7 feet and corner a stake;
 THENCE running N. 44-1/4 W. 344.75 feet, said line being center of proposed 60 foot street, and corner a stake;
 THENCE running S. 45 W. 4.25 feet and corner a stake which stake is south corner of Lot No. 33 of said Evans Park Addition;
 THENCE S. 31-1/2 E. 350 feet to the place of beginning, said plot containing 11,606.41 square feet, more or less, or 0.266 acres.

THIRD TRACT: All that certain tract or parcel of land out of the Zeno Phillips League, Brazos County, Texas, and a part of a tract of 8.6 acres of land conveyed by H.L. Lawler and wife Carrie A. Lawler, to R. L. Pou dated February 28, 1922, and recorded in Vol. 57, page 613, of the Brazos County Deed Records and the portion of said tract herein conveyed is described as follows:

Off of the north west side of said tract of land fronting twenty (20) feet on Bryan-College Road and running back S. 45 W. from said road a distance of 500 feet and being heretofore used as an easement for the owners of the twenty five (25) acres adjoining said 8.6 acre tract on the southwest. In a map of Pou's Addition to the City of Bryan, Texas, recorded in Vol. 38, page 585, of the Brazos County Deed Records, the land hereby conveyed is referred to as a public road.

TO HAVE AND TO HOLD the above described premises, together with all and singular the rights

and appurtenances thereto in anywise belonging unto the said

~~The City of Bryan, a Municipal Corporation, of Brazos County, Texas, its successors~~

~~do~~ and assigns forever and we do hereby bind ourselves, our,

heirs, executors and administrators, to Warrant and Forever Defend, all and singular the said premises

unto the said

~~The City of Bryan, a Municipal Corporation, of Brazos County, Texas, its successors,~~

~~do~~ and assigns, against every person whomsoever lawfully claiming, or to claim the same, or any part thereof.

But it is expressly agreed and stipulated that the Vendor's Lien is retained against the above described property, premises and improvements, until the above described note, and all interest thereon are fully paid according to its face and tenor, effect and reading, when this deed shall become absolute.

WITNESS our hands at Bryan, Texas,

this 9th day of December 19 39.

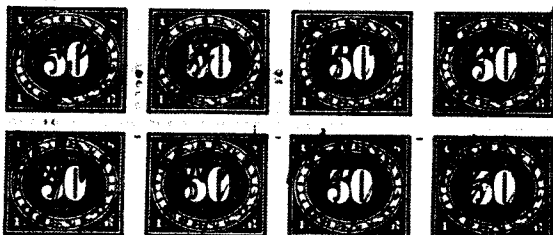

H. Williamson
Miss Pearl Williamson



SINGLE ACKNOWLEDGMENT

THE STATE OF TEXAS,
COUNTY OF

BEFORE ME, the undersigned, a Notary Public in and for said County and State, on this day personally appeared

known to me to be the person whose name subscribed to the foregoing instrument, and acknowledged to me that he executed the same for the purposes and consideration therein expressed.

GIVEN UNDER MY HAND AND SEAL OF OFFICE this the day of A.D. 19

(L. S.)

Notary Public in and for County, Texas

WIFE'S SEPARATE ACKNOWLEDGMENT

THE STATE OF TEXAS,
COUNTY OF

BEFORE ME, the undersigned, a Notary Public in and for said County and State, on this day personally appeared

, wife of , known

to me to be the person whose name is subscribed to the foregoing instrument, and having been examined by me privily and apart from her husband, and having the same fully explained to her, she, the said acknowledged such instrument to be her act and deed, and she declared that she had willingly signed the same for the purposes and consideration therein expressed, and that she did not wish to retract it.

GIVEN UNDER MY HAND AND SEAL OF OFFICE this the day of A. D. 19

(L. S.)

Notary Public in and for County, Texas

JOINT ACKNOWLEDGMENT

THE STATE OF TEXAS,
COUNTY OF BRAZOS

BEFORE ME, the undersigned, a Notary Public in and for said County and State, on this day personally appeared

H. H. Williamson and Mrs. Pearl Williamson, his wife, both known to me to be the persons whose names are subscribed to the foregoing instrument, and acknowledged to me that they each executed the same for the purposes and consideration therein expressed, and the said Mrs. Pearl Williamson, wife of the said H. H. Williamson

having been examined by me privily and apart from her husband, and having the same fully explained to her, she, the said Mrs. Pearl Williamson acknowledged such instrument to be her act and deed, and she declared that she had willingly signed the same for the purposes and consideration therein expressed, and that she did not wish to retract it.

GIVEN UNDER MY HAND AND SEAL OF OFFICE this the 9th day of December A. D. 19 39.

(L. S.)

Victoria Dominik
Notary Public in and for BRAZOS County, Texas

THE STATE OF TEXAS,
COUNTY OF Brazos

I HEREBY CERTIFY that the foregoing instrument of writing, with its certificate of authentication, was filed for record in my office on the 20 day of Dec, A. D. 19 39, at 10:30 o'clock P. M. and was duly recorded by me on the 20 day of Dec, A. D. 19 39 in Vol. 101 page 621, of the Records of said County.

WITNESS MY HAND and the Seal of the County Court of said County, at my office in Bryan the day and year last above written.

(L. S.)

FRANK WORSHAM
County Clerk Brazos County, Texas.

By Mrs. L. P. Newby Deputy

621
Warranty Book
(WITH VENDORS ITEM)

H. H. Williamson, et ux,
TO

The City of Bryan

FILED FOR RECORD

A. D. 19

This day of

at Filed for Record

At 10:30 clock A M
County Clerk

DEC 20 1939

By *Frank Edwards* Deputy
RECORDED DEPUTY

A. D. 19 39

In Book *101*, on Page *621*

In *Bryan* County Records

By *Frank Worsman* County Clerk

By *Wm. J. Brantley* Deputy

Recording Fee \$ *1.25*

This instrument should be filed immediately with
the County Clerk for record.

THE STATE OF TEXAS |

KNOW ALL MEN BY THESE PRESENTS:

COUNTY OF BRAZOS |

THAT the Bryan Country Club, acting herein by George G. Chance of Brazos County, Texas, as President, duly authorized and empowered to act under and by virtue of a resolution passed by said Bryan Country Club, a corporation, for the purpose of carrying out the Contract of Sale heretofore made by it, and the City of Bryan; and also for the purpose of carrying out a judgment of the District Court of Brazos County, Texas in Cause No. 13136, styled THE CITY OF BRYAN VS. BRYAN COUNTRY CLUB, IN THE DISTRICT COURT OF BRAZOS COUNTY, TEXAS; and for the consideration and purpose of cancelling and discharging the Deed of Trust Lien and other Liens held by said City of Bryan, and merging the legal title of said property into the City of Bryan, it being the legal owner and holder of said Notes and Liens as shown by said judgment and said Deed of Trust heretofore executed by it; the amount due on said Notes being in the sum of \$28,800.87, besides accrued interest and Attorney's fees; same being cancelled and discharged by this Deed, and by said judgment; have Granted, Sold and Conveyed, and by these presents do Grant, Sell and Convey unto the said City of Bryan of the County of Brazos, State of Texas, all that certain following described property:

89.35
5.6
5.0
12.5
112.4

The following described parcels of land all situated in Brazos County, Texas, in the Zeno Phillips League on the Bryan--College paved road:

FIRST TRACT: 89.35 acres of land deeded to Bryan Country Club, October 13th, 1916, by James-Batts and Ertle, recorded in Volume 45, pages 566 and 567, Deed Records of Brazos County, Texas.

SECOND TRACT: 5.6 acres of land deeded to Bryan Country Club February 19th, 1920, by B. Sbisal, recorded in Deed Records, Brazos County, Texas, Volume 50, page 419.

THIRD TRACT: 5 acres land deeded to Bryan Country Club August 7th, 1918, by H. T. Lawler and wife, Carrie Lawler, recorded in Volume 50, page 436, Deed Records of Brazos County, Texas.

FOURTH TRACT: 12.5 acres land deeded to Bryan Country Club September 24, 1921, by H. T. Lawler and wife Carrie Lawler, recorded in Volume 57, page 604, Deed Records of Brazos County, Texas,

together with all improvements situated thereon, or hereafter erected thereon.

BEING the same property described in the Deed of Trust

recorded in the Deed Records of Brazos County, Texas, in Volume "X", page 317; said property was conveyed in said Deed of Trust to Shearn Moody as Trustee for the benefit of the American National Insurance Company; said Deed of Trust being fully described in the judgment of the District Court of Brazos County, Texas, in Cause No. 13130, styled THE CITY OF BRYAN VS. BRYAN COUNTRY CLUB, IN THE DISTRICT COURT OF BRAZOS COUNTY, TEXAS.

TO HAVE AND TO HOLD the above described premises, together with all and singular, the rights and appurtenances thereto in anywise belonging unto the said CITY OF BRYAN, its successors and assigns forever; and the Bryan Country Club does hereby bind itself, its successors and assigns to Warrant and Forever Defend all and singular the said premises unto the said CITY OF BRYAN, its successors and assigns, against every person whomsoever lawfully claiming, or to claim the same, or any part thereof.

Witness the signature and seal of the Bryan Country Club at Bryan, Texas, this ^{26th} ~~27th~~ day of SEPTEMBER, A. D. 1939.

attest:-

BRYAN COUNTRY CLUB

Wm. L. Swirell
Secretary

By George G. Chance
President.



THE STATE OF TEXAS

COUNTY OF BRAZOS

Before me, the undersigned

authority, in and for Brazos County, Texas, on this day personally appeared George G. Chance, President of the Bryan Country Club, known to me to be the person whose name is subscribed to the foregoing instrument, and acknowledged to me that he executed the same as the act and deed of said Bryan Country Club and for the purposes and consideration therein expressed.

GIVEN UNDER MY HAND AND SEAL OF OFFICE, This 30th day of SEPTEMBER, A. D. 1939.

Aliver Trogon
Notary Public in and for Brazos County, Texas.

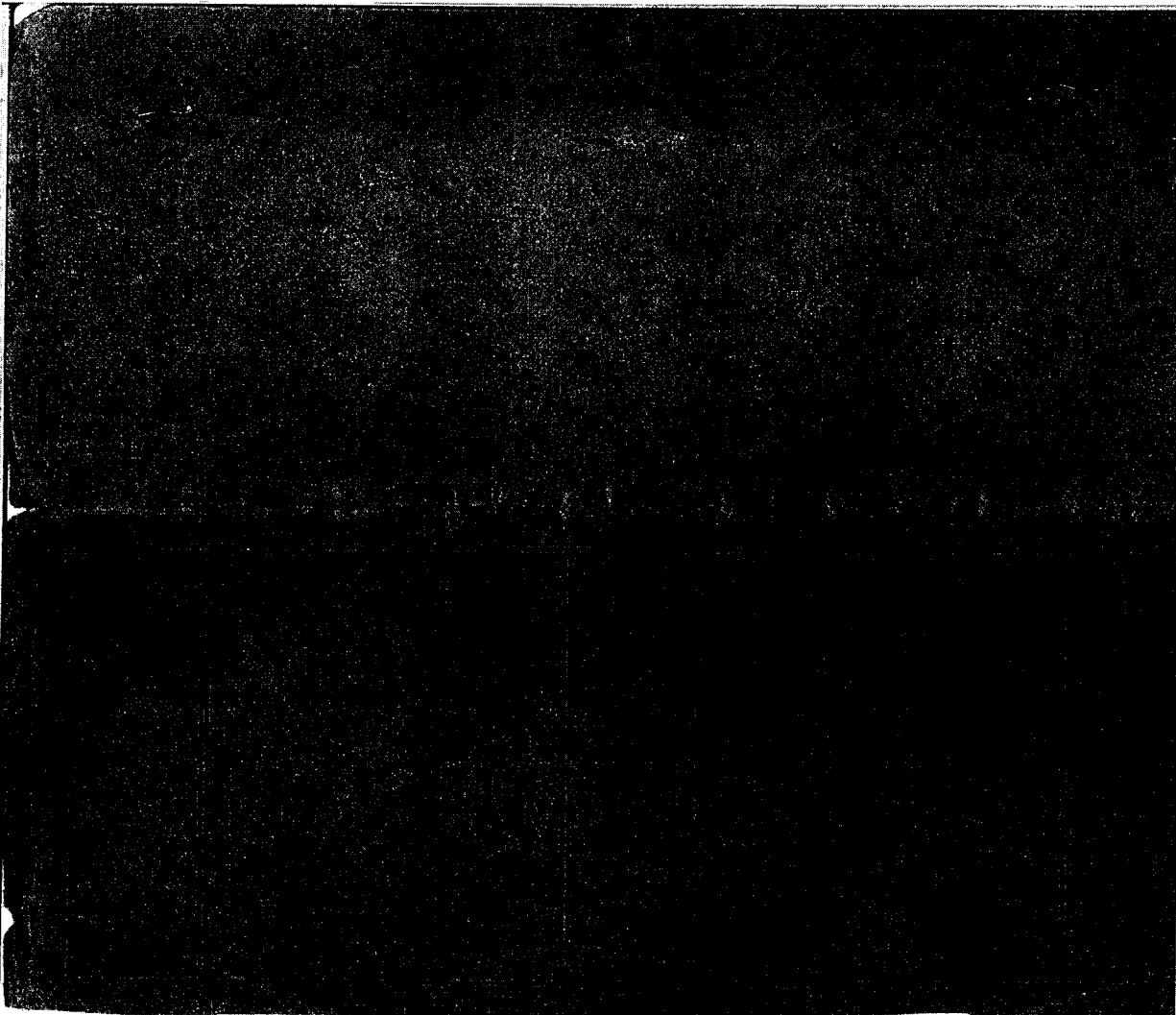

THE STATE OF TEXAS }
 COUNTY OF BRAZOS }

I, **FRANK MORSHAM**, County Clerk in and for said County, do hereby certify that the foregoing instrument dated the 26 day of Sept, A. D. 1939, together with its certificates of authentication, was filed for record in my office the 7 day of Oct, A. D. 1939, at 4:15 o'clock P. M., and duly recorded on the 7 records of Brazos County.

day of Oct page 251 in volume 101

WITNESS MY HAND AND OFFICIAL SEAL, At my office in Bryan, Texas, this 4 day of Oct, A. D. 1939.

By Mr. K. H. [Signature] Deputy County Clerk, Brazos County, Texas

(L.S.)

5

WORKSHEET 1.1
N/A

6

WORKSHEET 2.0

WORKSHEET 2.0

Impoundment/Dam Information

This worksheet **is required** for any impoundment, reservoir and/or dam. Submit an additional Worksheet 2.0 for each impoundment or reservoir requested in this application.

If there is more than one structure, the numbering/naming of structures should be consistent throughout the application and on any supplemental documents (e.g. maps).

1. Storage Information (Instructions, Page. 21)

- a. Official USGS name of reservoir, if applicable: Midtown Lake (formerly known as Country Club Lake)
- b. Provide amount of water (in acre-feet) impounded by structure at normal maximum operating level: 73 acre-feet.
- c. The impoundment is on-channel YES or off-channel _____ (mark one)
- i. Applicant has verified on-channel or off-channel determination by contacting Surface Water Availability Team at (512) 239-4600? Y / N YES
 - ii. If on-channel, will the structure have the ability to pass all State Water inflows that Applicant does not have authorization to impound? Y / N YES
- d. Is the impoundment structure already constructed? Y / N YES
- i. For already constructed **on-channel** structures:
 1. Date of Construction: 1920
 2. Was it constructed to be an exempt structure under TWC § 11.142? Y / N NO
 - a. If Yes, is Applicant requesting to proceed under TWC § 11.143? Y / N NO
 - b. If No, has the structure been issued a notice of violation by TCEQ? Y / N NO
 3. Is it a U.S. Natural Resources Conservation Service (NRCS) (formerly Soil Conservation Service (SCS)) floodwater-retarding structure? Y / N NO
 - a. If yes, provide the Site No. _____ and watershed project name _____;
 - b. Authorization to close "ports" in the service spillway requested? Y / N NO
 - ii. For **any** proposed new structures or modifications to structures:
 1. Applicant **must** contact TCEQ Dam Safety Section at (512) 239-0326, *prior to submitting an Application*. Applicant has contacted the TCEQ Dam Safety Section regarding the submission requirements of 30 TAC, Ch. 299? Y / N YES
Provide the date and the name of the Staff Person Levi Best 11/10/2021
 2. As a result of Applicant's consultation with the TCEQ Dam Safety Section, TCEQ has confirmed that:
 - a. No additional dam safety documents required with the Application. Y / N YES
 - b. Plans (with engineer's seal) for the structure required. Y / N NO
 - c. Engineer's signed and sealed hazard classification required. Y / N NO
 - d. Engineer's statement that structure complies with 30 TAC, Ch. 299 Rules required. Y / N NO

3. Applicants **shall** give notice by certified mail to each member of the governing body of each county and municipality in which the reservoir, or any part of the reservoir to be constructed, will be located. (30 TAC § 295.42). Applicant must submit a copy of all the notices and certified mailing cards with this Application. Notices and cards are included? Y / NYES

iii. Additional information required for **on-channel** storage:

1. Surface area (in acres) of on-channel reservoir at normal maximum operating level: 22.
2. Based on the Application information provided, Staff will calculate the drainage area above the on-channel dam or reservoir. If Applicant wishes to also calculate the drainage area they may do so at their option. Applicant has calculated the drainage area. Y/NYES
If yes, the drainage area is ^{1.44} sq. miles.
(If assistance is needed, call the Surface Water Availability Team prior to submitting the application, (512) 239-4600).

2. Structure Location (Instructions, Page. 23)

a. On Watercourse (if on-channel) (USGS name): Unnamed Tributary of Burton Creek

b. Zip Code: 77801

c. In the Zeno Phillips Grant Original Survey No. , Abstract No. 45,
Brazos County, Texas.

**** A copy of the deed(s) with the recording information from the county records must be submitted describing the tract(s) that include the structure and all lands to be inundated.***

*****If the Applicant is not currently the sole owner of the land on which the structure is or will be built and sole owner of all lands to be inundated, Applicant must submit documentation evidencing consent or other documentation supporting Applicant's right to use the land described.***

d. A point on the centerline of the dam (on-channel) or anywhere within the impoundment (off-channel) is:

Latitude 30.640103 °N, Longitude 96.359022 °W.

****Provide Latitude and Longitude coordinates in decimal degrees to at least six decimal places***

di. Indicate the method used to calculate the location (examples: Handheld GPS Device, GIS, Mapping Program): AutoCAD

dii. Map submitted which clearly identifies the Impoundment, dam (where applicable), and the lands to be inundated. See instructions Page. 15. Y / NYES

**SUPPLEMENT TO
WORKSHEET 2.0**

**NOTICE TO
GOVERNING BODIES**



Duane Peters
Brazos County Judge
200 South Texas Avenue, Ste. 332
Bryan, Texas 77803

December 14, 2021

CERTIFIED RETURN RECEIPT 7009 1410 0000 9212 2291

Dear Judge Peters,

This letter is to inform you that Mitchell and Morgan, on behalf of the City of Bryan, is submitting a Water Rights Permit to the Texas Commission on Environmental Quality (TCEQ) for approval to increase their water impoundment at Country Club Lake, located at the NW corner of Villa Maria Rd and South College Ave. The existing lake is located at coordinates N30.641397, W96.359719. The dam to the lake will be modified to support the request to increase its water impoundment on an unnamed tributary of Burton Creek in the new Travis Bryan Midtown Park. This notice is administered in compliance with 30 TAC § 295.42 and TCEQ's Water Rights Report application requirements.

Please contact us with any questions that you may have on the subject.

Thank you,

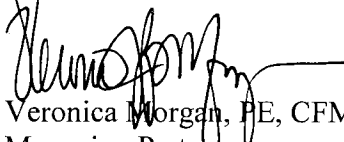
Veronica Morgan, PE, CFM
Managing Partner

cc: file

USPS TRACKING#



First-Class Mail
Postage & Fees Paid
USPS
Permit No. G-10

9590 9402 6967 1225 8090 61

United States
Postal Service

Sender: Please print your name, address, and ZIP+4® in this box*

Mitchell & Morgan
3204 Earl Rudder Fwy S.
College Station, TX 77845

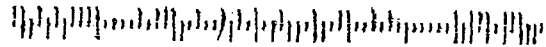

SENDER: COMPLETE THIS SECTION

- Complete items 1, 2, and 3.
- Print your name and address on the reverse so that we can return the card to you.
- Attach this card to the back of the mailpiece, or on the front if space permits.

1. Article Addressed to:

Duane Peters
200 S. TX Ave., Ste. 332
Bryan, TX 77803



9590 9402 6967 1225 8090 61

2. Article Number (Transfer from service label)

7009 1410 0000 9212 2291

COMPLETE THIS SECTION ON DELIVERY

A. Signature

X JD

- Agent
- Address

B. Received by (Printed Name)

JD

C. Date of Delivery

D. Is delivery address different from item 1? Yes
If YES, enter delivery address below: No

3. Service Type

- Adult Signature
- Adult Signature Restricted Delivery
- Certified Mail®
- Certified Mail Restricted Delivery
- Collect on Delivery
- Collect on Delivery Restricted Delivery
- Insured Mail
- Insured Mail Restricted Delivery (over \$500)
- Priority Mail Express®
- Registered Mail™
- Registered Mail Restricted Delivery
- Signature Confirmation®
- Signature Confirmation Restricted Delivery

PS Form 3811, July 2020 PSN 7530-02-000-9053

Domestic Return Receipt

U.S. Postal Service™
CERTIFIED MAIL™ RECEIPT

(Domestic Mail Only; No Insurance Coverage Provided)

For delivery information visit our website at www.usps.com

Bryan, TX 77803

Postage \$3.75

Certified Fee \$0.00

Return Receipt Fee (Endorsement Required) \$0.00

Restricted Delivery Fee (Endorsement Required) \$0.00

Total Postage & Fees \$7.38

0881
3

Postmark
Here

12/14/2021

Sent To

Duane Peters
Street, Apt. No.,
or PO Box No. 200 S. TX Ave., Ste. 332
City, State, ZIP+4
Bryan, TX 77803

PS Form 3800, August 2008

See Reverse for Instructions

7009 1410 0000 9212 2291

**SUPPLEMENT TO
WORKSHEET 2.0**

**CONSENT FOR
INUNDATED LAND**

Girl Scouts of Central Texas
Bryan/College Station Scout House
2512 Roundtree Drive
Bryan, TX 77801

To whom it may concern,

The City of Bryan has informed us of their plan to make modifications to Midtown Park Lake, formerly known as Country Club Lake. We understand that they will increase the current storage capacity of the lake from 73-acre feet to 120-acre feet. We have been informed of these modifications because our property, the Bryan/College Station Scout House, may have frontage on this lake. The exact boundary of the Scout property along the lake is in discussion with the City of Bryan and may end up where our acreage does not directly about the permanent pool of the lake. In any instance, the Girl Scouts of Central Texas hereby gives consent to these modifications and supports the City of Bryan's right to use the land as they have described per the request sent to the Texas Commission on Environmental Quality (TCEQ).

Please contact us with any questions that you may have on the subject.

Thanks you,



Paula Bookidis, CEO

3/31/2022

Girl Scouts of Central Texas

(Date)

**SUPPLEMENT TO
WORKSHEET 2.0**

**DRAINAGE
CALCULATION MAP**

7

WORKSHEET 3.0

WORKSHEET 3.0

DIVERSION POINT (OR DIVERSION REACH) INFORMATION

This worksheet **is required** for each diversion point or diversion reach. Submit one Worksheet 3.0 for **each** diversion point and two Worksheets for **each** diversion reach (one for the upstream limit and one for the downstream limit of each diversion reach).

The numbering of any points or reach limits should be consistent throughout the application and on supplemental documents (e.g. maps).

1. Diversion Information (Instructions, Page. 24)

a. This Worksheet is to add new (select 1 of 3 below):

1. 1 Diversion Point No.
2. Upstream Limit of Diversion Reach No.
3. Downstream Limit of Diversion Reach No.

b. Maximum Rate of Diversion for **this new point** _____ cfs (cubic feet per second)
or ⁵⁰⁰ _____ gpm (gallons per minute)

c. Does this point share a diversion rate with other points? Y / N NO
*If yes, submit Maximum **Combined** Rate of Diversion for all points/reaches* _____ cfs or _____ gpm

d. For amendments, is Applicant seeking to increase combined diversion rate? Y / N N/A

*** An increase in diversion rate is considered a new appropriation and would require completion of Section 1, New or Additional Appropriation of State Water.*

e. Check (✓) the appropriate box to indicate diversion location and indicate whether the diversion location is existing or proposed):

Check one		Write: Existing or Proposed
	Directly from stream	
✓	From an on-channel reservoir	PROPOSED
	From a stream to an on-channel reservoir	
	Other method (explain fully, use additional sheets if necessary)	

f. Based on the Application information provided, Staff will calculate the drainage area above the diversion point (or reach limit). If Applicant wishes to also calculate the drainage area, you may do so at their option.

Applicant has calculated the drainage area. Y / N YES

If yes, the drainage area is ^{1.44} _____ sq. miles.

(If assistance is needed, call the Surface Water Availability Team at (512) 239-4600, prior to submitting application)

2. Diversion Location (Instructions, Page 25)

- a. On watercourse (USGS name): Unnamed Tributary of Burton Creek
- b. Zip Code: 77801
- c. Location of point: In the Country Club Lake Addition Original Survey No. _____, Abstract No. Block 1, Lot 1 (part of) and Lot 2, BRAZOS County, Texas.

A copy of the deed(s) with the recording information from the county records must be submitted describing tract(s) that include the diversion structure.

For diversion reaches, the Commission cannot grant an Applicant access to property that the Applicant does not own or have consent or a legal right to access, the Applicant will be required to provide deeds, or consent, or other documents supporting a legal right to use the specific points when specific diversion points within the reach are utilized. Other documents may include, but are not limited to: a recorded easement, a land lease, a contract, or a citation to the Applicant's right to exercise eminent domain to acquire access.

- d. Point is at:
Latitude 30.641490 °N, Longitude 96.363416 °W.
Provide Latitude and Longitude coordinates in decimal degrees to at least six decimal places
- e. Indicate the method used to calculate the location (examples: Handheld GPS Device, GIS, Mapping Program): AutoCAD
- f. Map submitted must clearly identify each diversion point and/or reach. See instructions Page. 38.
- g. If the Plan of Diversion is complicated and not readily discernable from looking at the map, attach additional sheets that fully explain the plan of diversion.

**SUPPLEMENT TO
WORKSHEET 3.0**

**DIVERSION
POINT MAP**

8

WORKSHEET 4.0

**MIDTOWN PARK WELL #1
BVDO - 0286**

WORKSHEET 4.0 DISCHARGE INFORMATION

This worksheet required for any requested authorization to discharge water into a State Watercourse for conveyance and later withdrawal or in-place use. Worksheet 4.1 is also required for each Discharge point location requested. **Instructions Page. 26. Applicant is responsible for obtaining any separate water quality authorizations which may be required and for insuring compliance with TWC, Chapter 26 or any other applicable law.**

- a. The purpose of use for the water being discharged will be Irrigation.
- b. Provide the amount of water that will be lost to transportation, evaporation, seepage, channel or other associated carriage losses 0 % and explain the method of calculation: N/A - See supplemental documentation on page 69.

Is the source of the discharged water return flows? Y / N NO If yes, provide the following information:

1. The TPDES Permit Number(s) N/A (attach a copy of the **current** TPDES permit(s))
2. Applicant is the owner/holder of each TPDES permit listed above? Y / N N/A

PLEASE NOTE: If Applicant is not the discharger of the return flows, the application should be submitted under Section 1, New or Additional Appropriation of State Water, as a request for a new appropriation of state water. If Applicant is the discharger, then the application should be submitted under Section 3, Bed and Banks.

3. Monthly WWTP discharge data for the past 5 years in electronic format. (Attach and label as "Supplement to Worksheet 4.0").
 4. The percentage of return flows from groundwater N/A, surface water N/A ?
 5. If any percentage is surface water, provide the base water right number(s) N/A.
- c. Is the source of the water being discharged groundwater? Y / N YES If yes, provide the following information:

1. Source aquifer(s) from which water will be pumped: SPARTA
2. Any 24 hour pump test for the well if one has been conducted. If the well has not been constructed, provide production information for wells in the same aquifer in the area of the application. See <http://www.twdb.texas.gov/groundwater/data/gwdbbrpt.asp>. Additionally, provide well numbers or identifiers 59-21-510 AND 59-22-508.
3. Indicate how the groundwater will be conveyed to the stream or reservoir.
Groundwater will be discharged in a pipe to the channel and will flow by gravity to the impoundment.
4. A copy of the groundwater well permit if it is located in a Groundwater Conservation District (GCD) or evidence that a groundwater well permit is not required.

ci. Is the source of the water being discharged a surface water supply contract? Y / N NO
If yes, provide the signed contract(s).

cii. Identify any other source of the water N/A

WORKSHEET 4.0

**MIDTOWN PARK WELL #2
BVDO - 0287**

WORKSHEET 4.0 DISCHARGE INFORMATION

This worksheet required for any requested authorization to discharge water into a State Watercourse for conveyance and later withdrawal or in-place use. Worksheet 4.1 is also required for each Discharge point location requested. **Instructions Page. 26. Applicant is responsible for obtaining any separate water quality authorizations which may be required and for insuring compliance with TWC, Chapter 26 or any other applicable law.**

- a. The purpose of use for the water being discharged will be Irrigation.
- b. Provide the amount of water that will be lost to transportation, evaporation, seepage, channel or other associated carriage losses⁰ _____% and explain the method of calculation: N/A - See supplemental documentation on page 69.

Is the source of the discharged water return flows? Y / N NO If yes, provide the following information:

1. The TPDES Permit Number(s). N/A (attach a copy of the **current** TPDES permit(s))
2. Applicant is the owner/holder of each TPDES permit listed above? Y / N N/A

PLEASE NOTE: If Applicant is not the discharger of the return flows, the application should be submitted under Section 1, New or Additional Appropriation of State Water, as a request for a new appropriation of state water. If Applicant is the discharger, then the application should be submitted under Section 3, Bed and Banks.

3. Monthly WWTP discharge data for the past 5 years in electronic format. (Attach and label as "Supplement to Worksheet 4.0").
 4. The percentage of return flows from groundwater N/A, surface water N/A?
 5. If any percentage is surface water, provide the base water right number(s) N/A.
- c. Is the source of the water being discharged groundwater? Y / N YES If yes, provide the following information:

1. Source aquifer(s) from which water will be pumped: SPARTA
2. Any 24 hour pump test for the well if one has been conducted. If the well has not been constructed, provide production information for wells in the same aquifer in the area of the application. See <http://www.twdb.texas.gov/groundwater/data/gwdbbrpt.asp>. Additionally, provide well numbers or identifiers 59-21-510 AND 59-22-508.
3. Indicate how the groundwater will be conveyed to the stream or reservoir.
Groundwater will be discharged in a pipe to the channel and will flow by gravity to the impoundment.
4. A copy of the groundwater well permit if it is located in a Groundwater Conservation District (GCD) or evidence that a groundwater well permit is not required.

ci. Is the source of the water being discharged a surface water supply contract? Y / N NO
If yes, provide the signed contract(s).

cii. Identify any other source of the water N/A

**SUPPLEMENT TO
WORKSHEET 4.0**

**EVAPORATION
CALCULATIONS**



TCEQ Water Rights

Technical Report Worksheet 4.0

Evaporation Calculations

Table 1.0 below displays the calculations for the total evaporation of 67 acre-feet per year from the impoundment at Travis Bryan Midtown Park. The evaporation losses for bed and banks conveyance from each discharge point, Midtown Park Well #1 (BVDO-0286) and Midtown Park Well #2 (BVDO-0287), are considered negligible.

Table 1.0

MIDTOWN LAKE EVAPORATION CALCULATIONS		
Evap by WAM (by month)		
Evaporation Per Month	0.798	feet
Evaporation Per Day	0.3192	Inches
Area of Lake	22	Acres
Area of Lake	958,320	S.F.
Vol / Day (c.f.)	25,491	C.F.
Vol/Day (gal)	190,688.27	Gal
Reqd Flow rate (gpm)	132.42	Gal / Min
Evap by WAM (by year)		
Evaporation Per Year	3.029	feet
Evaporation Per Day	0.099583562	Inches
Area of Lake	22	Acres
Area of Lake	958,320	S.F.
Vol / Day (c.f.)	7,953	C.F.
Vol/Day (gal)	59,490.65	Gal
Reqd Flow rate (gpm)	41.31	Gal / Min
Evaporation annually (acft)	66.64	Acft

**SUPPLEMENT TO
WORKSHEET 4.0**

**SPARTA WELL
PUMP TESTS**

GWDB Reports and Downloads

Well Basic Details

Scanned Documents

State Well Number	5921510
County	Brazos
River Basin	Brazos
Groundwater Management Area	12
Regional Water Planning Area	G - Brazos G
Groundwater Conservation District	Brazos Valley GCD
Latitude (decimal degrees)	30.698889
Latitude (degrees minutes seconds)	30° 41' 56" N
Longitude (decimal degrees)	-96.451389
Longitude (degrees minutes seconds)	096° 27' 05" W
Coordinate Source	Global Positioning System - GPS
Aquifer Code	124SPRT - Sparta Sand
Aquifer	Sparta
Aquifer Pick Method	
Land Surface Elevation (feet above sea level)	321
Land Surface Elevation Method	Digital Elevation Model -DEM
Well Depth (feet below land surface)	540
Well Depth Source	Driller's Log
Drilling Start Date	
Drilling End Date	5/26/2006
Drilling Method	Mud (Hydraulic) Rotary
Borehole Completion	Filter Packed; 24" Underream

Well Type	Withdrawal of Water
Well Use	Public Supply
Water Level Observation	GCD Current Observation Well
Water Quality Available	Yes
Pump	Turbine
Pump Depth (feet below land surface)	
Power Type	Electric Motor
Annular Seal Method	Positive Displacement
Surface Completion	Surface Slab Installed
Owner	City of College Station (Sparta #1)
Driller	J & S Water Wells
Other Data Available	Drillers Log; Specific Capacity
Well Report Tracking Number	195663
Plugging Report Tracking Number	
U.S. Geological Survey Site Number	
Texas Commission on Environmental Quality Source Id	G0210002H
Groundwater Conservation District Well Number	
Owner Well Number	Sparta 1
Other Well Number	
Previous State Well Number	
Reporting Agency	Texas Commission on Environmental Quality
Created Date	7/8/2010
Last Update Date	10/10/2012

Remarks Owners Sparta #1 well. TCEQ ID #0210002H. Measured yield 1218 GPM with 81.6 feet drawdown after pump- ing 36 hours in 2006. Specific capacity 14.93 GPM/ft. Pumping level 214 feet. Pump set at 350 feet. Cemented from 0 to 441 feet. Underreamed and gravel packed.

Casing - No Data

Well Tests

Test Date	Test Type	Yield (gallons per minute)	Drawdown (ft.)	Test Hours
2006-05-26	Pump	1218	81.6	36

Lithology

Top Depth (ft.)	Bottom Depth (ft.)	Description
0	40	30-inch Conductor
40	44	Red Clay
44	65	Gray Sand & Rocks
65	92	Gray Clay & Sand Streaks
92	127	Gray Clay
127	185	Gray Shale
185	233	Rocks & Shale
233	243	Gray Sand & Shale Streaks
243	285	Gray Shale & Clay
285	333	Gray Semi-Coarse Sand
333	360	Gray Clay
360	365	Sand
365	420	Gray Clay
420	500	Light Gray Coarse Sand
500	520	Hard Rocks & Coarse Sand
520	577	Hard Gray Clay
577	600	Gray Sand & Rocks
600	630	Gray Sand
630	640	Rocks & Sand
640	688	Clay & Sand Streaks
688	780	Gray Sand Mixed with Some Rocks
780	790	Gray Clay
790	864	Gray Sand & Rocks

Annular Seal Range - No Data

Borehole

Diameter (in.)	Top Depth (ft.)	Bottom Depth (ft.)
36	0	40
24	40	441
18	441	540

Plugged Back - No Data

Filter Pack

Filter Material	Top Depth (ft.)	Bottom Depth (ft.)	Size
Gravel	361	540	

Packers - No Data

Water Level Measurements

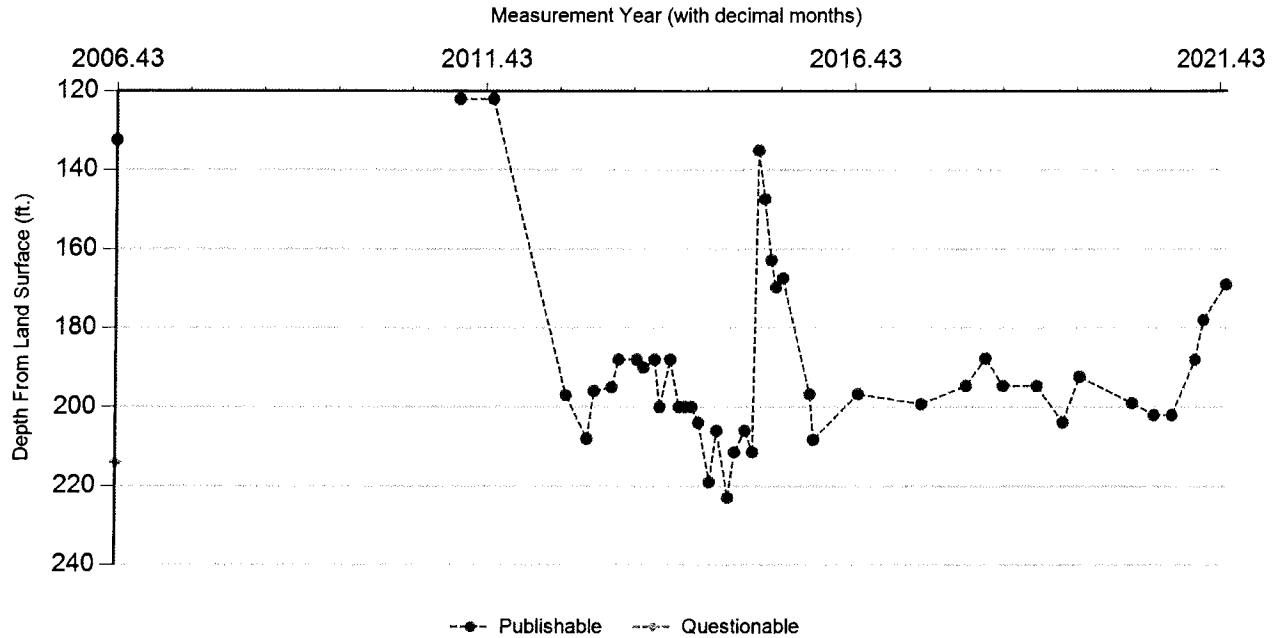

Status Code	Date	Time	Water Level (ft. below land surface)	Change value in () indicates rise in level	Water Elevation (ft. above sea level)	Meas #	Measuring Agency	Method	Remark ID	Comments
P	6/8/2006		132.4		188.6	1	Registered Water Well Driller	Unknown		
Q	6/9/2006		214	81.60	107	1	Registered Water Well Driller	Unknown	2	
P	1/26/2011		122	(92.00)	199	1	Groundwater Conservation District	Air Line		
P	7/11/2011		122	0.00	199	1	Groundwater Conservation District	Air Line		
P	7/11/2012		197	75.00	124	1	Groundwater Conservation District	Air Line		
P	10/25/2012		208	11.00	113	1	Groundwater Conservation District	Air Line		
P	11/30/2012		196	(12.00)	125	1	Groundwater Conservation District	Air Line		
P	2/22/2013		195	(1.00)	126	1	Groundwater Conservation District	Air Line		
P	3/26/2013		188	(7.00)	133	1	Groundwater Conservation District	Air Line		
P	6/26/2013		188	0.00	133	1	Groundwater Conservation District	Air Line		
P	7/30/2013		190	2.00	131	1	Groundwater Conservation District	Air Line		
P	9/26/2013		188	(2.00)	133	1	Groundwater Conservation District	Air Line		
P	10/21/2013		200	12.00	121	1	Groundwater Conservation District	Air Line		
P	12/13/2013		188	(12.00)	133	1	Groundwater Conservation District	Air Line		

Texas Water Development Board (TWDB)
Groundwater Database (GWDB)
Well Information Report for State Well Number
59-21-510

Status Code	Date	Time	Water Level (ft. below land surface)	Change value in () indicates rise in level	Water Elevation (ft. above sea level)	Meas #	Measuring Agency	Method	Remark ID	Comments
P	1/21/2014		200	12.00	121	1	Groundwater Conservation District	Air Line		
P	2/21/2014		200	0.00	121	1	Groundwater Conservation District	Air Line		
P	3/25/2014		200	0.00	121	1	Groundwater Conservation District	Air Line		
P	4/28/2014		204	4.00	117	1	Groundwater Conservation District	Air Line		
P	6/24/2014		219	15.00	102	1	Groundwater Conservation District	Air Line		
P	7/29/2014		206	(13.00)	115	1	Groundwater Conservation District	Air Line		
P	9/25/2014		222.9	16.90	98.1	1	Groundwater Conservation District	Air Line		
P	10/28/2014		211.4	(11.50)	109.6	1	Groundwater Conservation District	Air Line		
P	12/19/2014		206	(5.40)	115	1	Groundwater Conservation District	Air Line		
P	1/22/2015		211.4	5.40	109.6	1	Groundwater Conservation District	Air Line		
P	2/17/2015		135	(76.40)	186	1	Groundwater Conservation District	Air Line		
P	3/18/2015		147.3	12.30	173.7	1	Groundwater Conservation District	Air Line		
P	4/22/2015		162.8	15.50	158.2	1	Groundwater Conservation District	Air Line		
P	5/15/2015		169.7	6.90	151.3	1	Groundwater Conservation District	Air Line		
P	6/19/2015		167.4	(2.30)	153.6	1	Groundwater Conservation District	Air Line		
P	11/4/2015		196.75	29.35	124.25	1	Groundwater Conservation District	Air Line		
P	11/23/2015		208.3	11.55	112.7	1	Groundwater Conservation District	Air Line		
P	6/27/2016		196.75	(11.55)	124.25	1	Groundwater Conservation District	Air Line		
P	5/4/2017		199.27	2.52	121.73	1	Groundwater Conservation District	Air Line		
P	12/14/2017	14:2	194.65	(4.62)	126.35	1	Groundwater Conservation District	Air Line		
P	3/15/2018	12:4	187.72	(6.93)	133.28	1	Groundwater Conservation District	Air Line		
P	6/13/2018	9:00	194.65	6.93	126.35	1	Groundwater Conservation District	Air Line		
P	11/29/2018		194.65	0.00	126.35	1	Groundwater Conservation District	Air Line		Static
P	4/4/2019		203.89	9.24	117.11	1	Groundwater Conservation District	Air Line		Static
P	6/26/2019		192.34	(11.55)	128.66	1	Groundwater Conservation District	Air Line		Static
P	3/12/2020		199	6.66	122	1	Groundwater Conservation District	Air Line		Static
P	7/2/2020		202	3.00	119	1	Groundwater Conservation District	Air Line		Static

**Texas Water Development Board (TWDB)
Groundwater Database (GWDB)
Well Information Report for State Well Number
59-21-510**

Status Code	Date	Time	Water Level (ft. below land surface)	Change value in () indicates rise in level	Water Elevation (ft. above sea level)	Meas #	Measuring Agency	Method	Remark ID	Comments
P	10/7/2020		202	0.00	119	1	Groundwater Conservation District	Air Line		
P	2/4/2021		188	(14.00)	133	1	Groundwater Conservation District	Air Line		
P	3/18/2021		178	(10.00)	143	1	Groundwater Conservation District	Air Line		
P	7/14/2021		169	(9.00)	152	1	Groundwater Conservation District	Air Line		

Code Descriptions

Status Code	Status Description
P	Publishable
Q	Questionable

Remark ID	Remark Description
2	Pumping-level measurement

GWDB Reports and Downloads

Well Basic Details

Scanned Documents

State Well Number	5922508
County	Brazos
River Basin	Brazos
Groundwater Management Area	12
Regional Water Planning Area	G - Brazos G
Groundwater Conservation District	Brazos Valley GCD
Latitude (decimal degrees)	30.68
Latitude (degrees minutes seconds)	30° 40' 48" N
Longitude (decimal degrees)	-96.308334
Longitude (degrees minutes seconds)	096° 18' 30" W
Coordinate Source	Global Positioning System - GPS
Aquifer Code	124SPRT - Sparta Sand
Aquifer	Sparta
Aquifer Pick Method	
Land Surface Elevation (feet above sea level)	335
Land Surface Elevation Method	Digital Elevation Model -DEM
Well Depth (feet below land surface)	1080
Well Depth Source	Driller's Log
Drilling Start Date	
Drilling End Date	9/10/2003
Drilling Method	Mud (Hydraulic) Rotary
Borehole Completion	Gravel Pack w/Screen

Well Type	Withdrawal of Water
Well Use	Irrigation
Water Level Observation	GCD Current Observation Well
Water Quality Available	No
Pump	Turbine
Pump Depth (feet below land surface)	
Power Type	Electric Motor
Annular Seal Method	Slurry
Surface Completion	Surface Slab Installed
Owner	Miramont Country Club #3
Driller	J & S Water Wells
Other Data Available	Drillers Log
Well Report Tracking Number	66845
Plugging Report Tracking Number	
U.S. Geological Survey Site Number	
Texas Commission on Environmental Quality Source Id	
Groundwater Conservation District Well Number	
Owner Well Number	3
Other Well Number	
Previous State Well Number	
Reporting Agency	Texas Water Development Board
Created Date	3/19/2013
Last Update Date	3/19/2013

Remarks

Casing

Diameter (in.)	Casing Type	Casing Material	Schedule	Gauge	Top Depth (ft.)	Bottom Depth (ft.)
12	Blank	Steel			0	839
10	Screen	Stainless Steel			839	902
10	Blank	Steel			902	920
10	Screen	Stainless Steel			920	1060

Well Tests

Test Date	Test Type	Yield (gallons per minute)	Drawdown (ft.)	Test Hours
2003-09-10	Pump	934	295	8

Lithology

Top Depth (ft.)	Bottom Depth (ft.)	Description
0	40	24 inch Conductor
40	80	Sand
80	100	Clay
100	110	Sand
110	120	Clay
120	280	Sand and Rocks
280	320	Clay
320	340	Sand
340	390	Shale and Coal
390	400	Sand and Clay
400	570	Shale and Clay
570	586	Sand and Clay
586	660	Hard Clay
660	700	Clay and Rocks
700	780	Shale and Clay
780	830	Shale and Sand Streaks
830	900	Sand and Rocks
900	920	Clay and Shale
920	1060	Sand, Rocks, and Some Lignite
1060	1190	Hard Clay
1190	1240	Sand and Shale Streaks
1240	1280	Hard Rocks and Shale
1280	1300	Hard Sand
1300	1340	Hard Clay
1340	1360	Hard Sand
1360	1370	Clay
1370	1480	Clay and Sand Streaks
1480	1510	Sand and Rocks
1510	1546	Clay

Annular Seal Range - No Data

Borehole

Diameter (in.)	Top Depth (ft.)	Bottom Depth (ft.)
24	0	40
20	40	1080

Plugged Back - No Data

Filter Pack

Filter Material	Top Depth (ft.)	Bottom Depth (ft.)	Size
Gravel	400	1080	44 sacks

Packers - No Data

Water Level Measurements

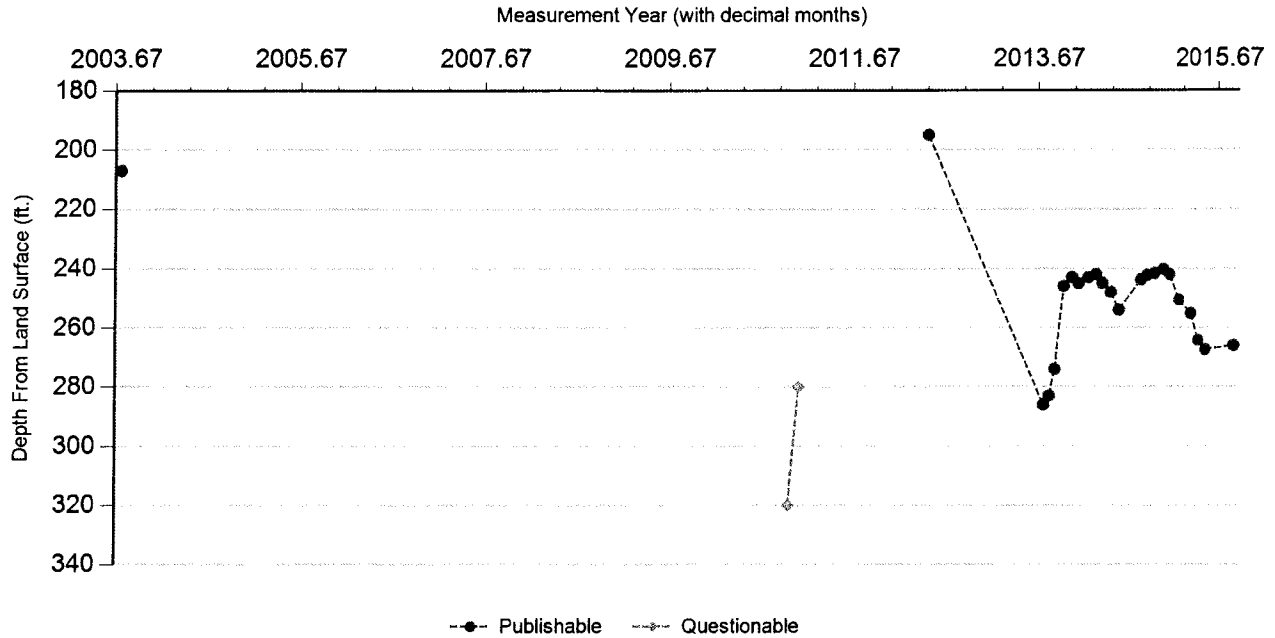

Status Code	Date	Time	Water Level (ft. below land surface)	Change value in () indicates rise in level	Water Elevation (ft. above sea level)	Meas #	Measuring Agency	Method	Remark ID	Comments
P	9/25/2003		207		128	1	Registered Water Well Driller	Unknown		
Q	12/20/2010		320	113.00	15	1	Groundwater Conservation District	Air Line	12	
Q	1/25/2011		280	(40.00)	55	1	Groundwater Conservation District	Air Line	12	
P	6/20/2012		195	(85.00)	140	1	Groundwater Conservation District	Air Line		
P	9/23/2013		286	91.00	49	1	Groundwater Conservation District	Air Line		
P	10/15/2013		283	(3.00)	52	1	Groundwater Conservation District	Air Line		
P	11/7/2013		274	(9.00)	61	1	Groundwater Conservation District	Air Line		
P	12/12/2013		246	(28.00)	89	1	Groundwater Conservation District	Air Line		
P	1/10/2014		243	(3.00)	92	1	Groundwater Conservation District	Air Line		
P	2/5/2014		245	2.00	90	1	Groundwater Conservation District	Air Line		
P	3/14/2014		243	(2.00)	92	1	Groundwater Conservation District	Air Line		
P	4/14/2014		242	(1.00)	93	1	Groundwater Conservation District	Air Line		
P	5/9/2014		245	3.00	90	1	Groundwater Conservation District	Air Line		
P	6/13/2014		248	3.00	87	1	Groundwater Conservation District	Air Line		

Texas Water Development Board (TWDB)
Groundwater Database (GWDB)
Well Information Report for State Well Number
59-22-508

Status Code	Date	Time	Water Level (ft. below land surface)	Change value in () indicates rise in level	Water Elevation (ft. above sea level)	Meas #	Measuring Agency	Method	Remark ID	Comments
P	7/15/2014		254	6.00	81	1	Groundwater Conservation District	Air Line		
P	10/13/2014		243.8	(10.20)	91.2	1	Groundwater Conservation District	Air Line		
P	11/7/2014		242.3	(1.50)	92.7	1	Groundwater Conservation District	Air Line		
P	12/8/2014		241.7	(0.60)	93.3	1	Groundwater Conservation District	Air Line		
P	1/9/2015		240.3	(1.40)	94.7	1	Groundwater Conservation District	Air Line		
P	2/6/2015		242.1	1.80	92.9	1	Groundwater Conservation District	Air Line		
P	3/16/2015		250.6	8.50	84.4	1	Groundwater Conservation District	Air Line		
P	5/7/2015		255.2	4.60	79.8	1	Groundwater Conservation District	Air Line		
P	6/9/2015		264.2	9.00	70.8	1	Groundwater Conservation District	Air Line		
P	7/10/2015		267.4	3.20	67.6	1	Groundwater Conservation District	Electric Line		
P	11/5/2015		266	(1.40)	69	1	Groundwater Conservation District	Air Line		

Code Descriptions

Status Code	Status Description
P	Publishable
Q	Questionable

Remark ID	Remark Description
12	Uncertain of reason for questionable measurement

**SUPPLEMENT TO
WORKSHEET 4.0**

**GROUNDWATER WELL
OPERATING PERMITS**



BRAZOS VALLEY GROUNDWATER CONSERVATION DISTRICT

P.O. Box 528 · HEARNE, TX 77859 · (979) 279-9350

[HTTPS://BRAZOSVALLEYGCD.ORG](https://brazosvalleygcd.org)

November 11, 2021

Jayson Barfknecht
Director of Utilities, City of Bryan
P.O. Box 1000
Bryan, Texas 77805

Dear Jayson,

Enclosed are Drilling/Operating permits BVDO-0286 and BVDO-0287 approved by the Brazos Valley Groundwater Conservation District Board of Directors on November 11, 2021 for Industrial use.

This well is subject to yearly water production fees that will be assessed at an Industrial rate of \$0.04625/1000 gallons produced. The well must be metered prior to production from the well and the annual water production reported to the District by no later than February 1st following the year of production.

Pertinent information you should be aware of is:

- This permit will be reviewed and evaluated for renewal in November 2026.
- A meter must be placed near the wellhead prior to the production of water.
- Enclosed is a copy of the most recently revised District Rules for your review.

If you have any questions concerning your permit, please feel free to contact me at 979-279-9350 (office) or 817-774-6412 (cell).

Best regards,

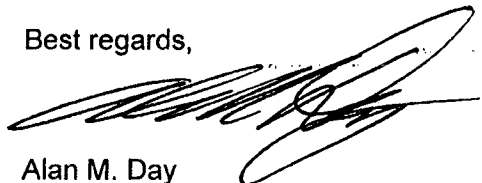

Alan M. Day

BOARD OF DIRECTORS:
JAYSON BARFKNECHT, SECRETARY
GARY MECHLER

STEPHEN CAST, PRESIDENT
DAVID STRATTA, TREASURER
LINDA PECINA

PETE BRIEN, VICE PRESIDENT
MARK CARRABBA
CHRIS ZEIG

Permit No. BVDO-0286

**Operating Permit
Issued By Direction of the Board of Directors of the
Brazos Valley Groundwater Conservation District**

This **Operating Permit** is granted to **City of Bryan** (Permittee) authorizing the Permittee to operate a water well known as **Midtown Park Well #1** ("Well") at the location specified below within the Brazos Valley Groundwater Conservation District (District) for the beneficial purpose of producing water for **Industrial** use. Permittee is authorized to operate the Well located at **N 30.641111° and W 96.364722°** to produce water from the **Sparta Aquifer** at an annual maximum capacity not to exceed **250 GPM** and a maximum annual production of **250 acre feet/year**.

Operating Permit Term:

- (a) An operating and drilling permit for a well or well site will automatically expire within three years from its issuance if the permitted well(s) has not been completed or is not significantly under development.
- (b) Unless specified otherwise by the Board or these Rules, operating permits are effective for five-year terms. At the end of each five-year term, the permit shall be renewed by the Board for an additional five-year term, upon submittal of a permit renewal application by the permit holder that provides adequate evidence of continued beneficial use for the permitted amount of water withdrawal. The District shall send notices to permit holders that contain the permit renewal applications, prior to permit expirations.
- (c) The District may amend or revoke an operating permit at any time if there is evidence of:
 - (1) the owner or operator of the well or well system has operated in violation of their permit, District Rules, or Chapter 36 of the Texas Water Code; or
 - (2) a change in the permit is required to prevent waste and achieve water conservation, minimize as far as practicable the drawdown of the water table or reduction of artesian pressure, lessen interference between wells, or control and prevent subsidence; or
 - (3) The permitted well(s) has not been completed, is not significantly under construction; or no significant progress is being made toward construction.

This permit is issued and effective as of November 11, 2021.

Special Provisions/Notes: None

This Permit is granted subject to these Rules, orders of the Board, and the laws of the State of Texas. In addition to any special provisions or other requirements incorporated into the permit issued by the District.

- (1) This Permit is granted in accordance with provisions of the Rules of the District, including amendments, and acceptance of this Permit constitutes an acknowledgment and agreement that Permittee will comply with the Rules of the District.
- (2) This Permit confers only the right to operate the permitted well under the provisions of the District Rules and its terms may be modified or amended pursuant to the provisions of those Rules. To protect the permit holder from the illegal use of a new landowner, within ten (10) days after the date of sale of property containing a well having been issued an operating permit, the operating permit holder must notify the District in writing of the name of the new owner. Any person who becomes the owner of a currently permitted well must, within forty-five (45) calendar days from the date of the change in ownership, file an application for a permit amendment to affect a transfer of the permit.
- (3) The operation of the well for the authorized purposes must be conducted in a non-wasteful manner.
- (4) All groundwater production from non-exempt wells in the District is required to be metered, except for the groundwater produced from wells in the Brazos River Alluvium aquifer. The District maintains the discretion to require meters on wells in the Brazos River Alluvium aquifer. Permittee shall maintain records of withdrawal on the property where the well is located or at its business office, and shall make those records available to the District for inspection. The Permittee shall submit complete, accurate, and timely metered pumpage and transport reports to the District annually, as requested by the District, no later than February first (1st) of each year.
- (5) The well site must be accessible to District representatives for inspection, and Permittee agrees to cooperate fully in any reasonable inspection of the well and well site by the District representatives.
- (6) The application pursuant to which this Permit has been issued is incorporated in this Permit, and this Permit is granted on the basis of and contingent upon the accuracy of the information supplied in that application. A finding that false information has been supplied is grounds for immediate revocation of the permit.
- (7) Violation of this Permit's terms, conditions, requirements, or special provisions, including pumping amounts in excess of authorized withdrawal, is punishable by civil penalties as provided by the District Rule 15.3, as well as revocation of the permit.
- (8) Permittee will use reasonable diligence to protect groundwater quality and will follow well-plugging guidelines at the time of well closure.

The issuance of this Permit does not grant to Permittee the right to use any private property, or any public property, for the production or conveyance of water. Neither does this permit authorize the invasion of any personal rights nor the violation of any federal, state, or local laws, rules or regulations. Further, the District makes no representations and shall have no responsibility with respect to the availability or quality of water authorized to be produced under this permit.

Brazos Valley Groundwater Conservation District

By: 
Alan M. Day, General Manager

11-11-21
Date

Permit No. BVDO-0287

**Operating Permit
Issued By Direction of the Board of Directors of the
Brazos Valley Groundwater Conservation District**

This **Operating Permit** is granted to **City of Bryan** (Permittee) authorizing the Permittee to operate a water well known as **Midtown Park Well #2** ("Well") at the location specified below within the Brazos Valley Groundwater Conservation District (District) for the beneficial purpose of producing water for **Industrial** use. Permittee is authorized to operate the Well located at **N 30.638611° and W 96.366944°** to produce water from the **Sparta Aquifer** at an annual maximum capacity not to exceed **250 GPM** and a maximum annual production of **250 acre feet/year**.

Operating Permit Term:

- (a) An operating and drilling permit for a well or well site will automatically expire within three years from its issuance if the permitted well(s) has not been completed or is not significantly under development.
- (b) Unless specified otherwise by the Board or these Rules, operating permits are effective for five-year terms. At the end of each five-year term, the permit shall be renewed by the Board for an additional five-year term, upon submittal of a permit renewal application by the permit holder that provides adequate evidence of continued beneficial use for the permitted amount of water withdrawal. The District shall send notices to permit holders that contain the permit renewal applications, prior to permit expirations.
- (c) The District may amend or revoke an operating permit at any time if there is evidence of:
 - (1) the owner or operator of the well or well system has operated in violation of their permit, District Rules, or Chapter 36 of the Texas Water Code; or
 - (2) a change in the permit is required to prevent waste and achieve water conservation, minimize as far as practicable the drawdown of the water table or reduction of artesian pressure, lessen interference between wells, or control and prevent subsidence; or
 - (3) The permitted well(s) has not been completed, is not significantly under construction; or no significant progress is being made toward construction.

This permit is issued and effective as of November 11, 2021.

Special Provisions/Notes: None

This Permit is granted subject to these Rules, orders of the Board, and the laws of the State of Texas. In addition to any special provisions or other requirements incorporated into the permit issued by the District.

- (1) This Permit is granted in accordance with provisions of the Rules of the District, including amendments, and acceptance of this Permit constitutes an acknowledgment and agreement that Permittee will comply with the Rules of the District.
- (2) This Permit confers only the right to operate the permitted well under the provisions of the District Rules and its terms may be modified or amended pursuant to the provisions of those Rules. To protect the permit holder from the illegal use of a new landowner, within ten (10) days after the date of sale of property containing a well having been issued an operating permit, the operating permit holder must notify the District in writing of the name of the new owner. Any person who becomes the owner of a currently permitted well must, within forty-five (45) calendar days from the date of the change in ownership, file an application for a permit amendment to affect a transfer of the permit.
- (3) The operation of the well for the authorized purposes must be conducted in a non-wasteful manner.
- (4) All groundwater production from non-exempt wells in the District is required to be metered, except for the groundwater produced from wells in the Brazos River Alluvium aquifer. The District maintains the discretion to require meters on wells in the Brazos River Alluvium aquifer. Permittee shall maintain records of withdrawal on the property where the well is located or at its business office, and shall make those records available to the District for inspection. The Permittee shall submit complete, accurate, and timely metered pumpage and transport reports to the District annually, as requested by the District, no later than February first (1st) of each year.
- (5) The well site must be accessible to District representatives for inspection, and Permittee agrees to cooperate fully in any reasonable inspection of the well and well site by the District representatives.
- (6) The application pursuant to which this Permit has been issued is incorporated in this Permit, and this Permit is granted on the basis of and contingent upon the accuracy of the information supplied in that application. A finding that false information has been supplied is grounds for immediate revocation of the permit.
- (7) Violation of this Permit's terms, conditions, requirements, or special provisions, including pumping amounts in excess of authorized withdrawal, is punishable by civil penalties as provided by the District Rule 15.3, as well as revocation of the permit.
- (8) Permittee will use reasonable diligence to protect groundwater quality and will follow well-plugging guidelines at the time of well closure.

The issuance of this Permit does not grant to Permittee the right to use any private property, or any public property, for the production or conveyance of water. Neither does this permit authorize the invasion of any personal rights nor the violation of any federal, state, or local laws, rules or regulations. Further, the District makes no representations and shall have no responsibility with respect to the availability or quality of water authorized to be produced under this permit.

Brazos Valley Groundwater Conservation District

By: 
Alan M. Day, General Manager

11-11-21
Date

9

WORKSHEET 4.1

**MIDTOWN PARK WELL #1
BVDO - 0286**

WORKSHEET 4.1

DISCHARGE POINT INFORMATION

This worksheet is required for **each** discharge point. Submit one Worksheet 4.1 for each discharge point. If there is more than one discharge point, the numbering of the points should be consistent throughout the application and on any supplemental documents (e.g. maps).
Instructions, Page 27.

For water discharged at this location provide:

- a. The amount of water that will be discharged at this point is ²⁵⁰_____ acre-feet per year. The discharged amount should include the amount needed for use and to compensate for any losses.
- b. Water will be discharged at this point at a maximum rate of _____ cfs or ²⁵⁰_____ gpm.
- c. Name of Watercourse as shown on Official USGS maps: Unnamed Tributary of Burton Creek
- d. Zip Code 77801
- f. Location of point: In the Country Club Lake Addition Original Survey No. _____, Abstract No. Block 1, Lot 1 (pt. of) and Lot 2, BRAZOS County, Texas.
- g. Point is at:
Latitude 30.641111 °N, Longitude 96.364722 °W.
****Provide Latitude and Longitude coordinates in decimal degrees to at least six decimal places***
- h. Indicate the method used to calculate the discharge point location (examples: Handheld GPS Device, GIS, Mapping Program): AutoCAD

Map submitted must clearly identify each discharge point. See instructions Page. 15.

WORKSHEET 4.1

MIDTOWN PARK WELL #2

BVDO - 0287

WORKSHEET 4.1 DISCHARGE POINT INFORMATION

This worksheet is required for **each** discharge point. Submit one Worksheet 4.1 for each discharge point. If there is more than one discharge point, the numbering of the points should be consistent throughout the application and on any supplemental documents (e.g. maps).
Instructions, Page 27.

For water discharged at this location provide:

- a. The amount of water that will be discharged at this point is 250 acre-feet per year. The discharged amount should include the amount needed for use and to compensate for any losses.
- b. Water will be discharged at this point at a maximum rate of _____ cfs or 250 gpm.
- c. Name of Watercourse as shown on Official USGS maps: Unnamed Tributary of Burton Creek
- d. Zip Code 77801
- f. Location of point: In the Country Club Lake Addition Original Survey No. _____, Abstract No. Block 1, Lot 1 (pt. of) and Lot 2, BRAZOS County, Texas.
- g. Point is at:
Latitude 30.638611 °N, Longitude 96.366944 °W.
****Provide Latitude and Longitude coordinates in decimal degrees to at least six decimal places***
- h. Indicate the method used to calculate the discharge point location (examples: Handheld GPS Device, GIS, Mapping Program): AutoCAD

Map submitted must clearly identify each discharge point. See instructions Page. 15.

**SUPPLEMENT TO
WORKSHEET 4.1**

**DISCHARGE POINTS
MAP**

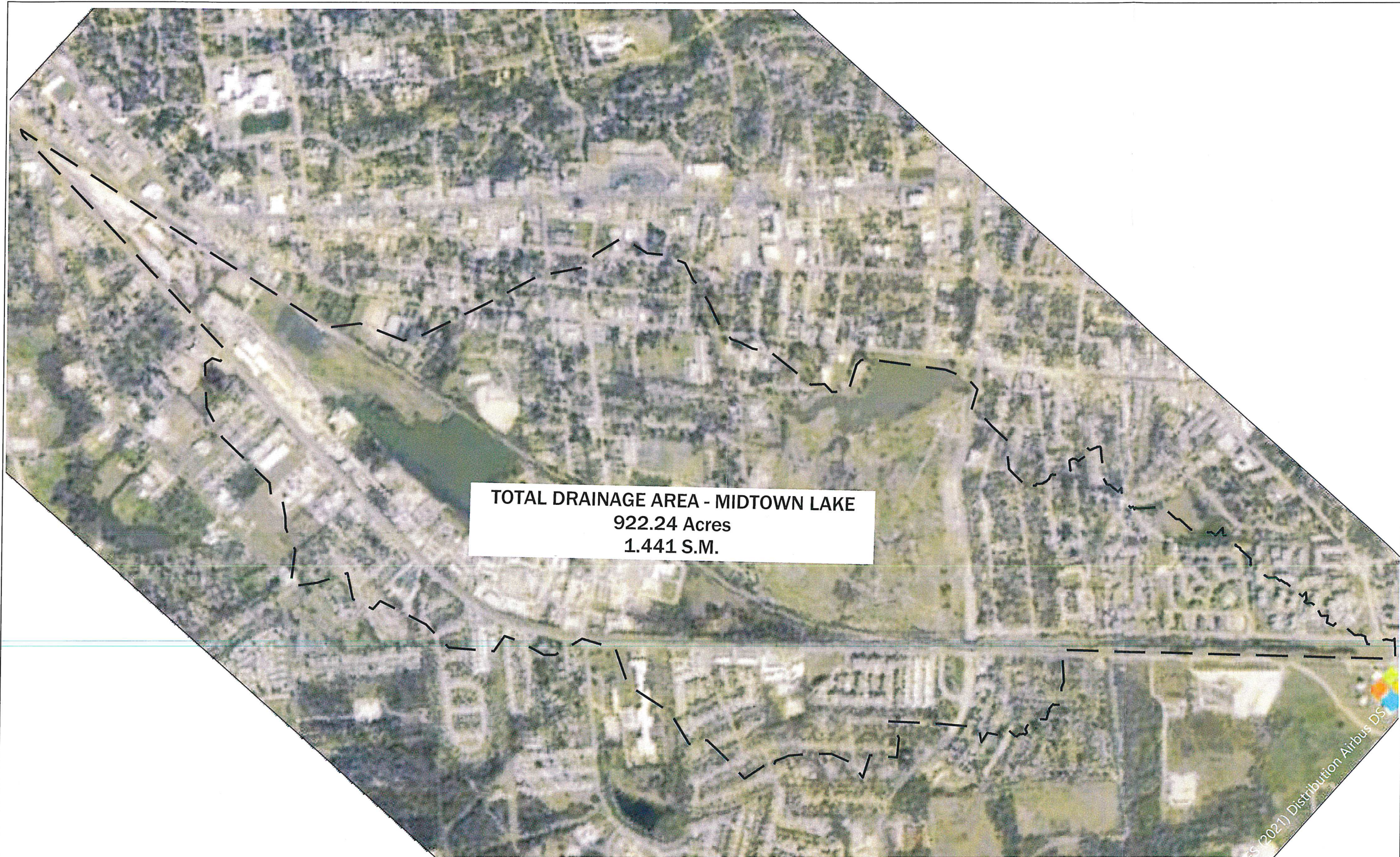

TOTAL DRAINAGE AREA - MIDTOWN LAKE
 922.24 Acres
 1.441 S.M.

**MITCHELL
 MORGAN**

T.979.260.6963
 F.979.260.3564
 FIRM# F-1443
 3204 EARL RUDDER FWY S
 COLLEGE STATION, TX 77845

PLAN & DESIGN SPECIALISTS IN
 CIVIL ENGINEERING • HYDRAULICS
 HYDROLOGY • UTILITIES • STREETS
 SITE PLANS • SUBDIVISIONS
 www.mitchellandmorgan.com

DECEMBER, 2021
 Designed By: JM
 Drawn By: JM

Prepared For:
 TCEQ Water Availability
 Division, MC-160
 P.O. Box 13087
 Austin, TX 78711

Revisions

DRAINAGE CALCULATION MAP
TRAVIS BRYAN PARK—MIDTOWN

DA

**SUPPLEMENT TO
WORKSHEET 2.0**

**DAM LOCATION
MAP**

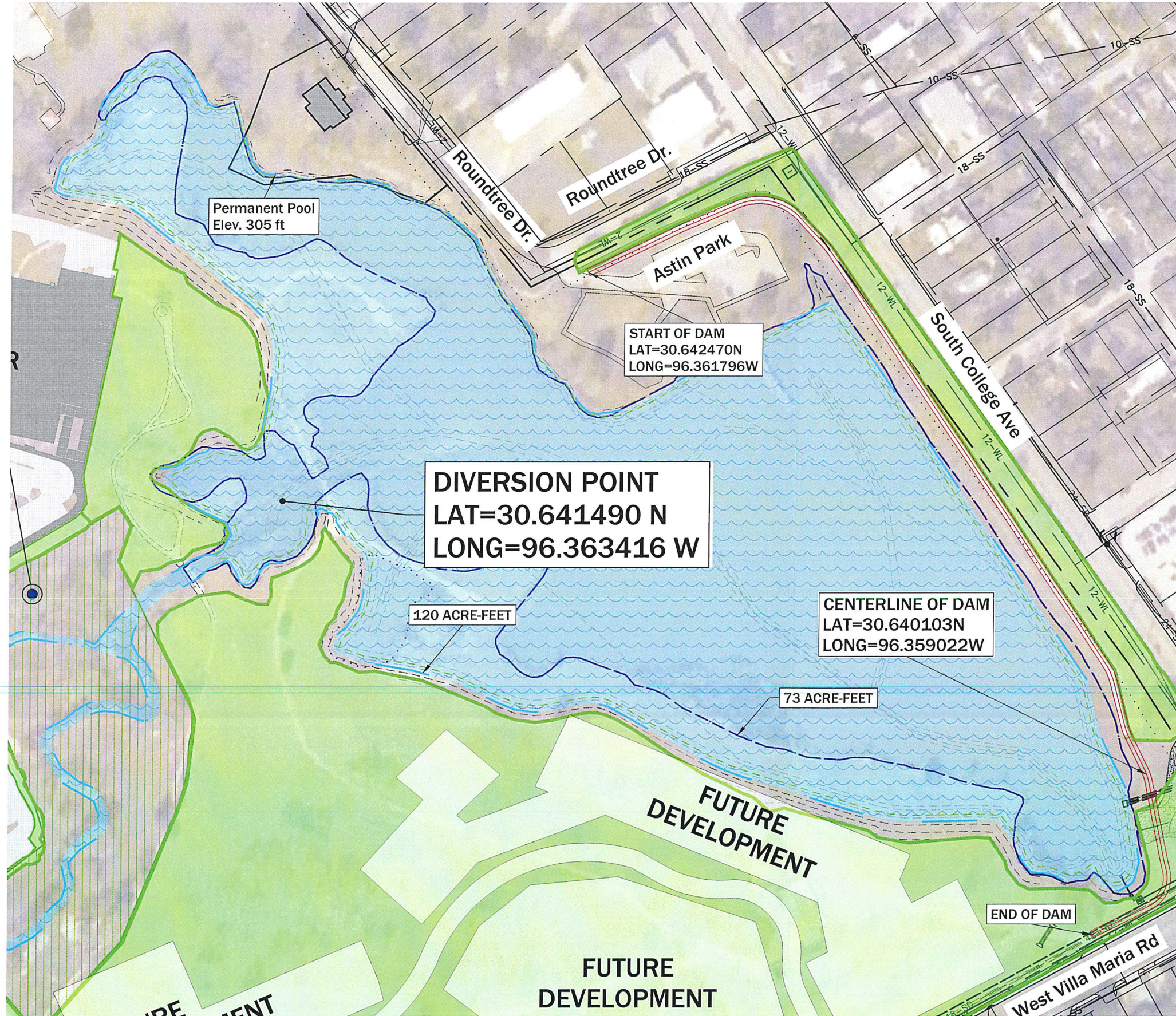

LEGEND

- Normal Pool Lake Elev=305.00
- - - - - Waters of the US (WOTUS)
- - - - - Interim Lake Edge (Elev=303.3)
- Country Club Lake Dam
- ▭ Proposed Irrigated Areas
- ▭ Future Lake
- ▭ Greenbelt Reserve Area



T.979.260.6963
 F.979.260.3564
 TX FIRM # F-1443
 3204 EARL RUDDER FWY. S.
 COLLEGE STATION, TX 77845

PLAN & DESIGN SPECIALISTS IN
 CIVIL ENGINEERING HYDRAULICS
 HYDROLOGY UTILITIES STRUKETS
 SITE PLANS SUBDIVISIONS
 www.mitchellandmorgan.com

December, 2021
 Designed By: JIM
 Drawn By: JB
 Checked By: JIM

Prepared For:
 TCEQ Water Availability
 Division, MC-160
 P.O. Box 13087
 Austin, TX 78711

Revisions

**COUNTRY CLUB LAKE DAM
 LOCATION MAP
 MIDDTOWN PARK**



LEGEND

	Normal Pool Lake Elev=305.00 FT
	Waters of the US (WOTUS)
	Interim Lake Edge (Elev=303.3 FT)
	Country Club Lake Dam
	Proposed Irrigated Areas
	Future Lake
	Greenbelt Reserve Area

MIDTOWN PARK WELL #1
(BVDO-0286) 250 GPM
LAT=30.641111 N
LONG=96.364722 W

DIVERSION POINT
LAT=30.641490 N
LONG=96.363416 W

MIDTOWN PARK WELL #2
(BVDO-0287) 250 GPM
LAT=30.638611 N
LONG=96.366944 W



T.979.260.6963
F.979.260.3564
TX. FIRM # F-1443

3204 EARL RUDDER FWY. S.
COLLEGE STATION, TX 77845

PLAN & DESIGN SPECIALISTS IN
CIVIL ENGINEERING HYDRAULICS
HYDROLOGY UTILITIES STREETS
SITE PLANS SUBDIVISIONS

For Review Purposes Only
Not to be used for construction
without the approval of the
Professional Engineer, P.E.
November 11, 2021

DECEMBER 2021
Designed by: JIM
Drawn by: SE
Checked by: VISHI

Prepared For:
TCEQ Water Availability
Division, MC-160
P.O. Box 13087
Austin, TX 78711

Revisions

WATER RIGHTS PERMIT LOCATION MAP
MIDTOWN PARK

EX2

10

WORKSHEET 5.0

WORKSHEET 5.0

ENVIRONMENTAL INFORMATION

1. Impingement and Entrainment

This section is required for any new diversion point that is not already authorized. Indicate the measures the applicant will take to avoid impingement and entrainment of aquatic organisms (ex. Screens on any new diversion structure that is not already authorized in a water right). **Instructions, Page 29.**

See attached document on pg.97

2. New Appropriations of Water (Canadian, Red, Sulphur, and Cypress Creek Basins only) and Changes in Diversion Point(s)

This section is required for new appropriations of water in the Canadian, Red, Sulphur, and Cypress Creek Basins and in all basins for requests to change a diversion point. **Instructions, Page 30.**

Description of the Water Body at each Diversion Point or Dam Location. (Provide an Environmental Information Sheet for each location),

a. Identify the appropriate description of the water body.

Stream

Reservoir

Average depth of the entire water body, in feet: 5 feet

Other, specify: _____

b. Flow characteristics

If a stream, was checked above, provide the following. For new diversion locations, check one of the following that best characterize the area downstream of the diversion (check one).

Intermittent - dry for at least one week during most years

Intermittent with Perennial Pools - enduring pools

Perennial - normally flowing

Check the method used to characterize the area downstream of the new diversion location.

USGS flow records

Historical observation by adjacent landowners

Personal observation

Other, specify: _____

c. Waterbody aesthetics

Check one of the following that best describes the aesthetics of the stream segments affected by the application and the area surrounding those stream segments.

- Wilderness: outstanding natural beauty; usually wooded or unpastured area; water clarity exceptional
- Natural Area: trees and/or native vegetation common; some development evident (from fields, pastures, dwellings); water clarity discolored
- Common Setting: not offensive; developed but uncluttered; water may be colored or turbid
- Offensive: stream does not enhance aesthetics; cluttered; highly developed; dumping areas; water discolored

d. Waterbody Recreational Uses

Are there any known recreational uses of the stream segments affected by the application?

- Primary contact recreation (swimming or direct contact with water)
- Secondary contact recreation (fishing, canoeing, or limited contact with water)
- Non-contact recreation

Submit the following information in a Supplemental Attachment, labeled Addendum to Worksheet 5.0:

1. Photographs of the stream at the diversion point or dam location. Photographs should be in color and show the proposed point or reservoir and upstream and downstream views of the stream, including riparian vegetation along the banks. Include a description of each photograph and reference the photograph to the map submitted with the application indicating the location of the photograph and the direction of the shot.
2. If the application includes a proposed reservoir, also include:
 - i. A brief description of the area that will be inundated by the reservoir.
 - ii. If a United States Army Corps of Engineers (USACE) 404 permit is required, provide the project number and USACE project manager.
 - iii. A description of how any impacts to wetland habitat, if any, will be mitigated if the reservoir is greater than 5,000 acre-feet.

3. Alternate Sources of Water and/or Bed and Banks Applications

This section is required for applications using an alternate source of water and bed and banks applications in any basins. **Instructions, page 31.**

- a. For all bed and banks applications:
 - i. Submit an assessment of the adequacy of the quantity and quality of flows remaining after the proposed diversion to meet instream uses and bay and estuary freshwater inflow requirements.
- b. For all alternate source applications:
 - i. If the alternate source is treated return flows, provide the TPDES permit number N/A
 - ii. If groundwater is the alternate source, or groundwater or other surface water will be discharged into a watercourse provide:
Reasonably current water chemistry information including but not limited to the following parameters in the table below. Additional parameters may be requested if there is a specific water quality concern associated with the aquifer from which water is withdrawn. If data for onsite wells are unavailable; historical data collected from similar sized wells drawing water from the same aquifer may be provided. However, onsite data may still be required when it becomes available. Provide the well number or well identifier. Complete the information below for each well and provide the Well Number or identifier.

Parameter	Average Conc.	Max Conc.	No. of Samples	Sample Type	Sample Date/Time
Sulfate, mg/L	1	1	1	TWDB Protocols	Nov. 6, 2007
Chloride, mg/L	14.3	16	2	TWDB Protocols	'07 and '12
Total Dissolved Solids, mg/L	190	194	2	TWDB Protocols	Nov. 2007 and Sept. 2012
pH, standard units	8.825	8.95	2	TWDB Protocols	'07 and '12
Temperature*, degrees Celsius	25.2	25.2	1	TWDB Protocols	Sept. 20, 2012

* Temperature must be measured onsite at the time the groundwater sample is collected.

- iii. If groundwater will be used, provide the depth of the well UNKNOWN and the name of the aquifer from which water is withdrawn Sparta.

SUPPLEMENT TO WORKSHEET 5.0

**IMPINGEMENT AND
ENTRAINMENT**



TCEQ Water Rights

Technical Report Worksheet 5.0

Impingement and Entrainment

The City of Bryan will ensure that all design and construction phases of the diversion point located approximately at 30.641690 N, 96.363416 W, will avoid impingement and entrainment of aquatic organisms. Thorough research will be conducted to include proper screening on the diversion pipe, meeting all necessary standards. No further design details are known at this time.

SUPPLEMENT TO WORKSHEET 5.0

**ASSESSMENT OF
ADEQUACY**



TCEQ Water Rights

Technical Report Worksheet 5.0

Assessment of Adequacy

The application only requests to discharge and subsequently divert groundwater from the Sparta Aquifer. The amount of water diverted will not exceed the amount of water discharged, less losses. There will be no impacts on downstream flows or freshwater inflows from the request in this application.

11

WORKSHEET 6.0
N/A

12

WORKSHEET 7.0

WORKSHEET 7.0

ACCOUNTING PLAN INFORMATION WORKSHEET

The following information provides guidance on when an Accounting Plan may be required for certain applications and if so, what information should be provided. An accounting plan can either be very simple such as keeping records of gage flows, discharges, and diversions; or, more complex depending on the requests in the application. Contact the Surface Water Availability Team at 512-239-4600 for information about accounting plan requirements, if any, for your application. **Instructions, Page 34.**

1. Is Accounting Plan Required

Accounting Plans are generally required:

- For applications that request authorization to divert large amounts of water from a single point where multiple diversion rates, priority dates, and water rights can also divert from that point;
- For applications for new major water supply reservoirs;
- For applications that amend a water right where an accounting plan is already required, if the amendment would require changes to the accounting plan;
- For applications with complex environmental flow requirements;
- For applications with an alternate source of water where the water is conveyed and diverted; and
- For reuse applications.

2. Accounting Plan Requirements

- a. A **text file** that includes:
 1. an introduction explaining the water rights and what they authorize;
 2. an explanation of the fields in the accounting plan spreadsheet including how they are calculated and the source of the data;
 3. for accounting plans that include multiple priority dates and authorizations, a section that discusses how water is accounted for by priority date and which water is subject to a priority call by whom; and
 4. Should provide a summary of all sources of water.

- b. A **spreadsheet** that includes:
 1. Basic daily data such as diversions, deliveries, compliance with any instream flow requirements, return flows discharged and diverted and reservoir content;
 2. Method for accounting for inflows if needed;
 3. Reporting of all water use from all authorizations, both existing and proposed;
 4. An accounting for all sources of water;
 5. An accounting of water by priority date;
 6. For bed and banks applications, the accounting plan must track the discharged water from the point of delivery to the final point of diversion;
 7. Accounting for conveyance losses;
 8. Evaporation losses if the water will be stored in or transported through a reservoir. Include changes in evaporation losses and a method for measuring reservoir content resulting from the discharge of additional water into the reservoir;
 9. An accounting for spills of other water added to the reservoir; and
 10. Calculation of the amount of drawdown resulting from diversion by junior rights or diversions of other water discharged into and then stored in the reservoir.

SUPPLEMENT TO WORKSHEET 7.0

**ACCOUNTING PLAN
TEXT FILE**



**CITY OF BRYAN
DAILY WATER BALANCE
WATER ACCOUNTING PLAN
PERMIT NO. BVDO-0286 AND BVDO-0287**

INTRODUCTION

Permit No. BVDO-0286 and Permit No. BVDO-0287 are operating permits issued by direction of the Board of Directors of the Brazos Valley Groundwater Conservation District. These operating permits grant the City of Bryan authorization to operate water wells Midtown Park Well #1 (under permit BVDO-0286) and Midtown Park Well #2 (under permit BVDO-0287) for industrial use at their specified locations. Midtown Park Well #1 is located at 30.641111 N, 96.364722 W, and Midtown Park Well #2 is located at 30.638611 N, 96.366944 W. The City of Bryan has been authorized to produce water from the Sparta Aquifer at an annual maximum capacity not to exceed 250 GPM per well and a maximum annual production of 250-acre feet/year per well for both the Midtown Park Well #1 and the Midtown Park Well #2.

Both Midtown Park Well #1 and Midtown Park Well #2 will be used to discharge groundwater into Midtown Lake to maintain permanent pool at a total of 120-acre feet. Groundwater will then be diverted out of Midtown Lake and used to irrigate the adjacent Midtown Park. Subsequently, Midtown Park Well #1 and Midtown Park Well #2 will discharge groundwater back into Midtown Lake to maintain permanent pool.

DAILY WATER BALANCE ACCOUNTING SPREADSHEET

The following are descriptions of the data contained in each column of the Daily Water Balance Accounting Spreadsheet.

Column 1: Day, month, and year for which the discharge data apply.

Column 2: Amount of groundwater discharged from Midtown Park Well #1 BVDO-0286 at 30.641111 N, 96.364722 W in gallons per day for that date.

Column 3: Amount of groundwater discharged from Midtown Park Well #2 BVDO-0287 at 30.638611 N, 96.366944 W in gallons per day for that date.

Column 4: Amount of water discharged to Midtown Lake. Calculation is the total of Columns 2 and 3.

Column 5: Amount of groundwater lost due to evaporation of Midtown Lake in gallons per day.

Column 6: Diversion point #1 from Midtown Lake.

Column 7: Day, month, and year for which the diversion data apply.

Column 8: Amount of groundwater available for use at diversion point #1 located at 30.641490 N, 96.363416 W in gallons per day for that date. Calculation is Column 4 minus Column 5 and Column 6.

Column 9: Amount of groundwater diverted at diversion point #1 located at 30.641490 N, 96.363416 W in gallons per day for that date.

Column 10: Amount of groundwater remaining at diversion point #1 location after groundwater is diverted. Calculation is Column 8 minus Column 9.

SUPPLEMENT TO WORKSHEET 7.0

**ACCOUNTING PLAN
SPREADSHEET**

**City of Bryan
 Water Rights Per
 Daily Water Bal**

Col 1	Col 2	Col 10
Discharge (Date)	Discharge diverted at Midtown Point #1 (BVDO-0) N 30.6411) W 96.3647%	Remaining Amount (gpd) column 11-12
1-Jan-23	100,000.0	9,312.0

13

WORKSHEET 8.0

WORKSHEET 8.0 CALCULATION OF FEES

This worksheet is for calculating required application fees. Applications are not Administratively Complete until all required fees are received. **Instructions, Page. 34**

1. NEW APPROPRIATION

	Description	Amount (\$)
Filing Fee	Circle fee correlating to the total amount of water* requested for any new appropriation and/or impoundment. Amount should match total on Worksheet 1, Section 1. Enter corresponding fee under Amount (\$) . <u>In Acre-Feet</u> a. Less than 100 \$100.00 b. 100 - 5,000 \$250.00 c. 5,001 - 10,000 \$500.00 d. 10,001 - 250,000 \$1,000.00 e. More than 250,000 \$2,000.00	
Recording Fee		\$25.00
Agriculture Use Fee	<i>Only for those with an Irrigation Use.</i> Multiply 50¢ x _____ Number of acres that will be irrigated with State Water. **	
Use Fee	<i>Required for all Use Types, excluding Irrigation Use.</i> Multiply \$1.00 x _____ Maximum annual diversion of State Water in acre-feet. **	
Recreational Storage Fee	<i>Only for those with Recreational Storage.</i> Multiply \$1.00 x _____ acre-feet of in-place Recreational Use State Water to be stored at normal max operating level.	
Storage Fee	<i>Only for those with Storage, excluding Recreational Storage.</i> Multiply 50¢ x _____ acre-feet of State Water to be stored at normal max operating level.	
Mailed Notice	Cost of mailed notice to all water rights in the basin. Contact Staff to determine the amount (512) 239-4600.	997.34
TOTAL		\$997.34

2. AMENDMENT OR SEVER AND COMBINE

	Description	Amount (\$)
Filing Fee	Amendment: \$100 OR Sever and Combine: \$100 x ___ of water rights to combine	100
Recording Fee		\$12.50
Mailed Notice	Additional notice fee to be determined once application is submitted.	
TOTAL INCLUDED		\$112.50

3. BED AND BANKS

	Description	Amount (\$)
Filing Fee		\$100.00
Recording Fee		\$12.50
Mailed Notice	Additional notice fee to be determined once application is submitted.	
TOTAL INCLUDED		\$

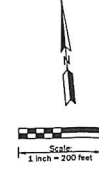

LEGEND

- Normal Pool Lake Elev= 305.00 FT
- - - - - Waters of the US (WOTUS)
- - - - - Interim Lake Edge (Elev=303.3 FT)
- Country Club Lake Dam
- Proposed Irrigated Areas
- Future Lake
- Greenbelt Reserve Area



T.979.260.6963
F.979.260.3564
TX FIRM # F-1443

3204 EARL RUDDER FWY, S.
COLLEGE STATION, TX 77845

PLAN & DESIGN SPECIALISTS IN
CIVIL ENGINEERING HYDROLOGICALS
MICROLOGY UTILITIES STREETS
SITE PLANS SUBDIVISIONS

For Review Only
Not to be used for construction,
contract administration, or
any other purpose without the
written consent of Mitchell
M&M Morgan, P.C.
No. 71289
DECEMBER, 2021

DECEMBER, 2021
Designed by: JIM
Checked by: JBM

Prepared For:
TCEQ Water Availability
Division, MC-160
P.O. Box 13087
Austin, TX 78711

Revisions

WATER RIGHTS PERMIT LOCATION MAP
MIDTOWN PARK

EX2